

210\*143MM

SOLAR POWERED  
STARBURST  
STRING LIGHT



INTRODUCTION

Solar lights work by using power generated by the solar panel to charge internal batteries. These batteries are then used to power the light. When switched on the lights automatically illuminate at night by using a light sensor. The duration of illumination will depend on the amount of sunlight and therefore charge received by the batteries.

CONTENTS

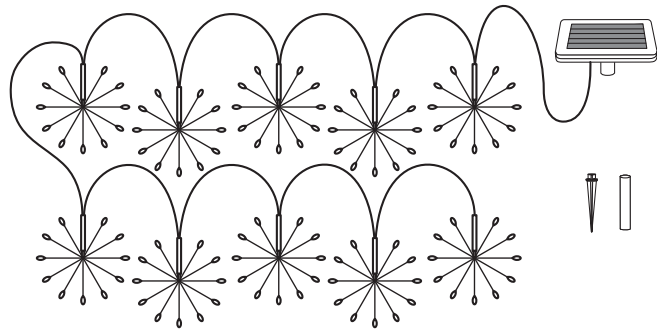

Design may vary.  
This is not a toy. Keep away from children and pets.

1

FUNCTION

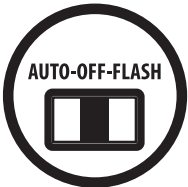

(AUTO) On  
(OFF) Off  
(FLASH) Flashing



150 warm white LED



Outdoor use.



No mains required.



Rechargeable batteries become less efficient with repeated charge-discharge cycles and the battery capacity reduces. If battery becomes less efficient try boost charging it by leaving in the off position for 3 to 5 sunny days to allow the maximum charge to the battery.

2

FIRST USE

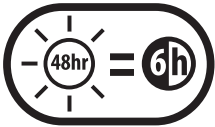

Leave switch in "OFF" position for 2 sunny days. Remove the "Try Me" wire connecting the product to the packaging by gently pulling it out of the solar panel. This will not impact the performance of the product.

PERFORMANCE

	Spring	Summer	Autumn	Winter
Light run time	4-6h	6-8h	4-6h	2-4h

POSITION

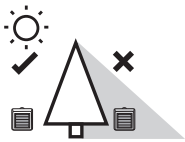

Position the solar panel to receive the maximum amount of sunlight.

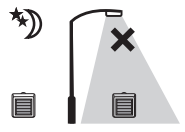

Do not position under bright light as this will prevent the light switching on at night.

3

CHANGE BATTERY

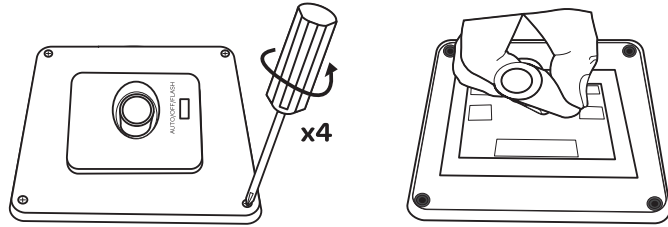

BATTERY SPECIFICATION

1 x 1.2V AA Ni-CD 600mAh battery required (included).

PROBLEM SOLVING

1. Check the solar panel is positioned correctly.
2. Check the battery and boost charge as described.
3. If problems persist contact customer services.

4