

 **real**
living™

BANCROFT 3PC ALL WEATHER WICKER GLIDER SET

ASSEMBLY INSTRUCTIONS

ITEM# : GBO24-002 / GBO24-002NAVY

SKU# : 810669627 / 810680146

Need help? We are here for you! 1-888-733-8169 Toll Free

Or email us at customerservice_01@yeah.net, customerservice_02@yeah.net

customerservice_03@yeah.net

GENERAL BEST PRACTICES FOR ASSEMBLY:

- Read all instructions before starting.
- Clear a flat covered space to begin assembly.
 - Always best to do it with a friend.
- Note that hardware required is provided for every step.
 - Pay attention to orientation .
- Number of the hardware corresponds to its letter in the package.
 - Helpful hints provided along the way.

WARNINGS:

• Use the correct screws as indicated. All screws should be hand tightened until the complete piece is assembled (This will make the assembly process much easier). Once the piece is fully assembled, then go back and tighten all screws with provided tool.

- Keep all children and pets away from assembly area.

Children and pets should be supervised when they are in the area of the product construction.

- Keep assembly area at least 6 feet from any obstruction such as a fence, garage, house, overhanging branches, laundry line or electrical wires.

- Some parts may contain sharp edges. When assembling and using this product, basic safety precautions should always be followed to reduce the risk of personal injury and damage to the product. Please read all instructions before assembly and use.

- The chair and table are not to be used for standing purposes and will not function as a stool or step-ladder. Use on even surfaces only.

• The chair is used at weight of 250lb (113.6kg). Improper use of this product or failure to use as directed may result in injury. Not intended for commercial use.

MAINTENANCE :

- **STAIN RESISTANT CUSHIONS CARE — KEEP THE CUSHIONS IN STORAGE ON RAINY DAYS.**

- **SPILLS:** Immediately wipe up the spill using a white damp cloth. Repeat process if necessary until stain is gone. Allow cushions to air dry.

- **FABRIC CARE:** Hand wash cold, non-chlorine bleach when needed, lay flat to dry. Cool iron if necessary. Do not dry clean.

- **ALL WEATHER WICKER PRODUCT CARE**

Before using, clean the product completely with a soft dry towel. When not in use, wipe free of any dirt or loose objects, wash with a mild solution of soap and water, rinse thoroughly and dry completely. Do not use strong detergent or abrasive cleaners. Screws can loosen over a period of usage, please check the screws occasionally and re-tighten if necessary.

PARTS LIST



A

1PC Left Arm



B

1PC Right Arm



C

1PC Chair Back

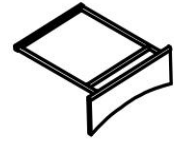

D

1PC Seat Panel



E

1PC U-shaped Fitting



F

1PC Chair Base

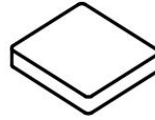

N

1PC Seat Cushion



O

1PC Back Cushion

HARDWARE LIST



M

4PC Spring Washer



I

18PC Washer



J

8PC Nut



M6*15

G

4PC Screw(M6x15mm)



M6*35

H

14PC Screw(M6x35mm)



K

1PC Allen Wrench



L

1PC Open End Wrench

STEP 1

Assemble chair back (C) to left arm (A) by inserting the steel pins.
Then secure with 2 screws (G) and 2 washers (I) by using allen wrench (K). Do not fully tighten all screws now.

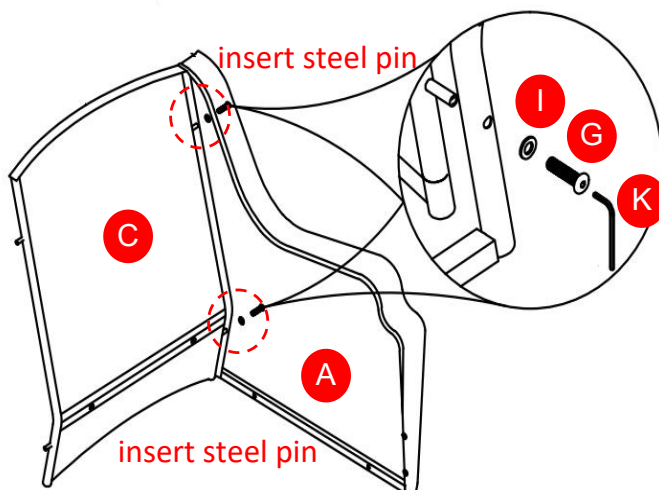

STEP 2

Assemble chair back (C) to right arm (B) by inserting the steel pins. Then secure with 2 screws (G) and 2 washers (I) by using allen wrench (K). Do not fully tighten all screws now.

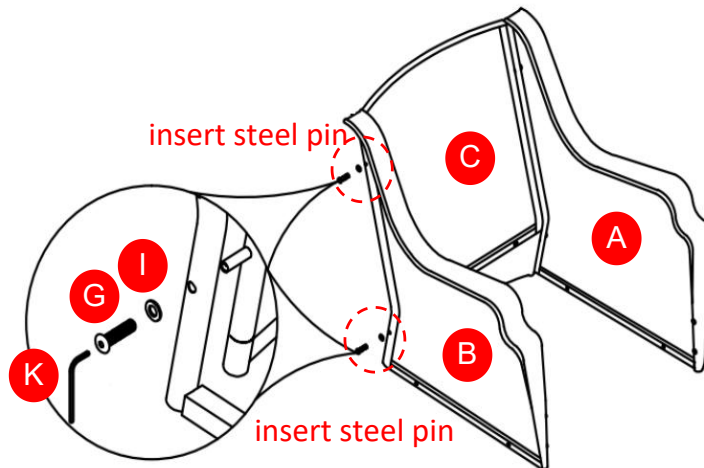

STEP 3

Secure seat panel (D) to assembled left arm (A) and right arms (B) with 4 screws (H) and 4 washers (I) by using allen wrench (K). Do not fully tighten all screws now.

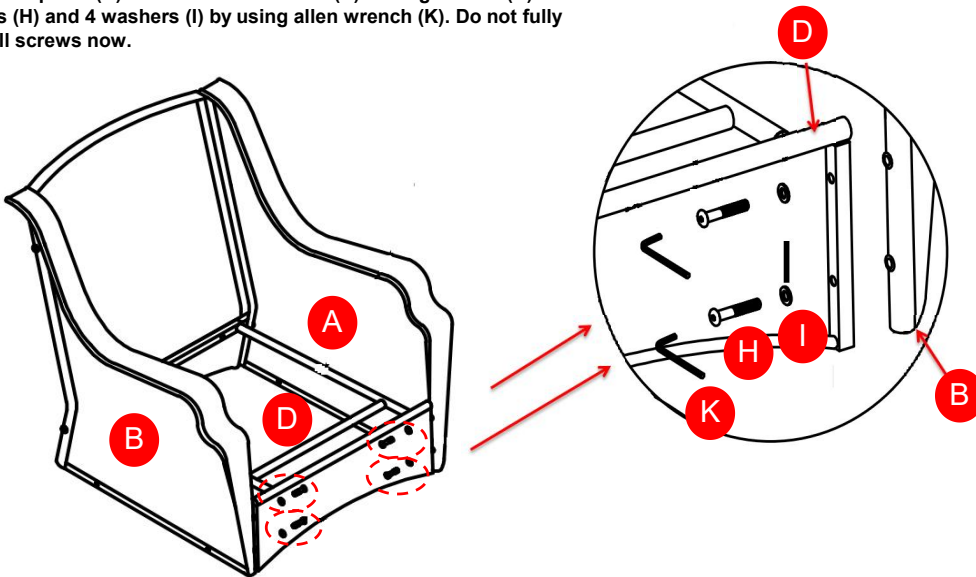

STEP 4

Secure seat panel (D) to assembled chair back (C) with 2 screws (H) and 2 washers (I) by using allen wrench (K), verify the alignment and adjust, fully tighten all the screws now.

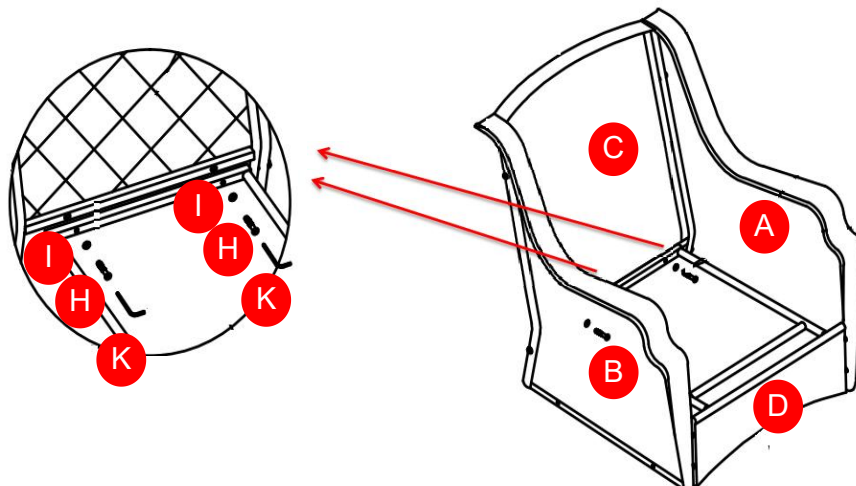

STEP 5

Turn over the assembled chair bucket and secure the swing arms on U-shaped fitting (E) to the bottom tube of left arm (A) and right arm (B) with 4 screws (H), and 4 nuts (J) with allen wrench (K) and open end wrench (L).

NOTE: PLEASE FIX TWO SCREWS IN DIAGONAL POSITION TO KEEP THE BALANCE THEN FIX THE OTHER TWO SCREWS.

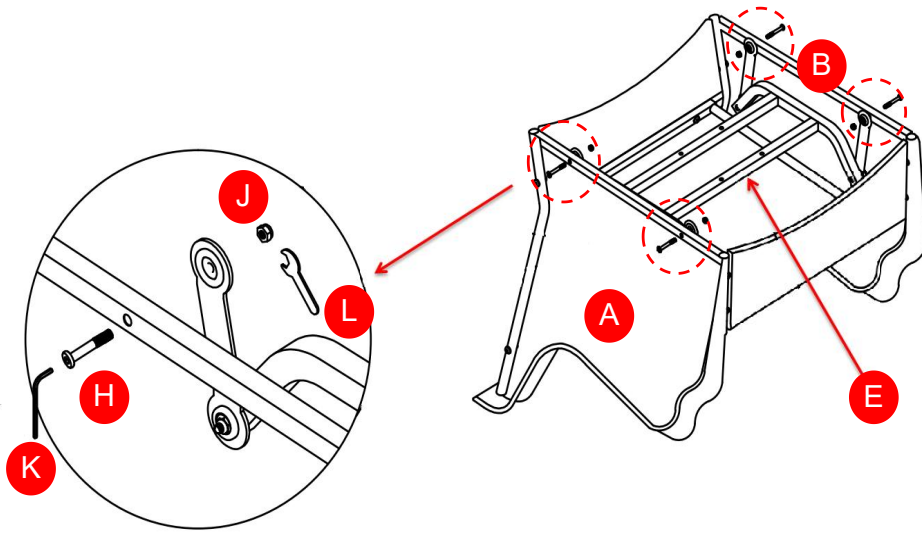

STEP 6

Push the top plate on the base (F) with different position to make the holes open for ready assembling. Connect the 4 screws (H) through the holes of the plate on the base (F) and the holes on the tube of U-shaped fitting (E) with 8 washers (I), 4 spring washers (M) and 4 Nuts (J) by using allen wrench (K) and open end wrench (L).

NOTE: THIS STEP IS VERY IMPORTANT. DO READ THE INSTRUCTION AND DIAGRAM CAREFULLY.

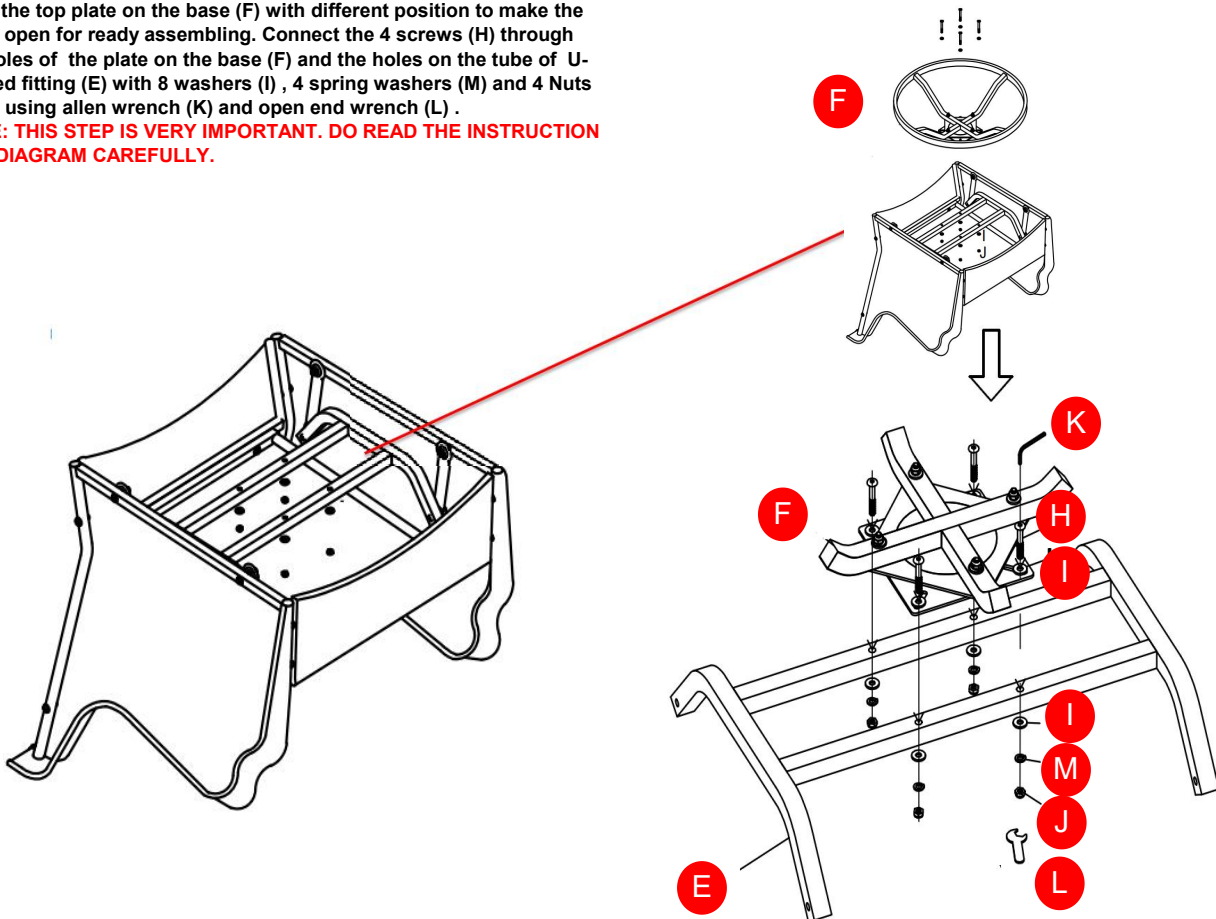

STEP 7

Put seat cushion (N) and back cushion (O) on the chair. The chair is assembled.

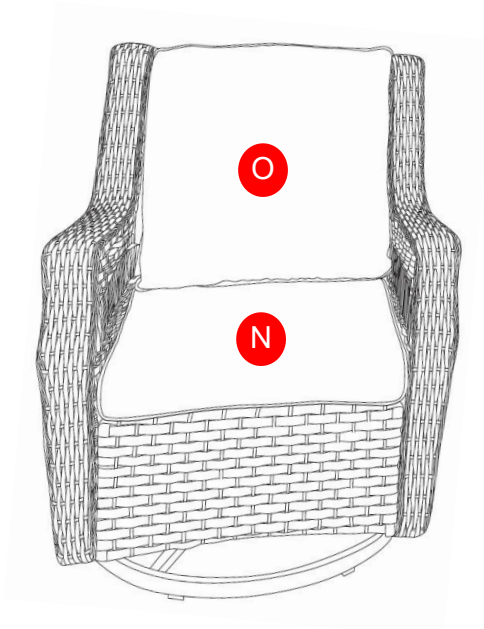

SPECIAL WARNING:

THIS CHAIR IS NOT A TOY. DON'T OVER-SWING THE CHAIR. OVER-SWING THE CHAIR MAYBE MAKE THE CHAIR TIP OVER AND RESULT IN INJURY. DO NOT STAND ON THE CHAIR. ANY IMPROPER USE OF THIS PRODUCT MAY RESULT IN INJURY.



Warranty

One year limited warranty.

Proof of purchase (dated register receipt) is required for warranty claims.

It remains the customer's responsibility for freight and packing charges to and from the service center.

PARTS LIST



P

4PC Table Leg



Q

1PC Table Top



R

1PC Table Tray

HARDWARE LIST



I

12PC Washer

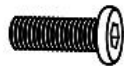

S

12PC Screw(M6x12mm)

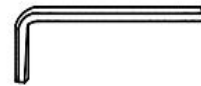

K

1PC Allen Wrench

STEP 1

Secure 4 table legs (P) to table top (Q) by using 8 screws (S) and 8 washers (I) with allen wrench (K). Do not fully tighten all screws now.

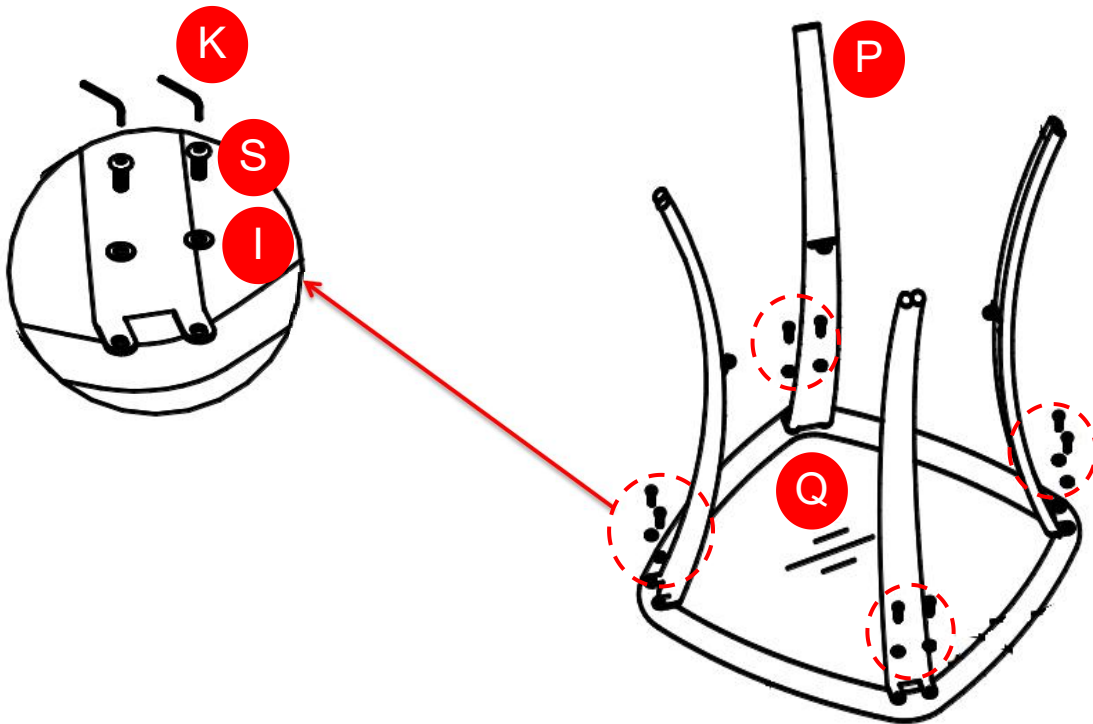

STEP 2

Secure table tray (R) to 4 table legs (P) by using 4 screws (S) and 4 washers (I) with allen wrench (K). Do not fully tighten all screws now.

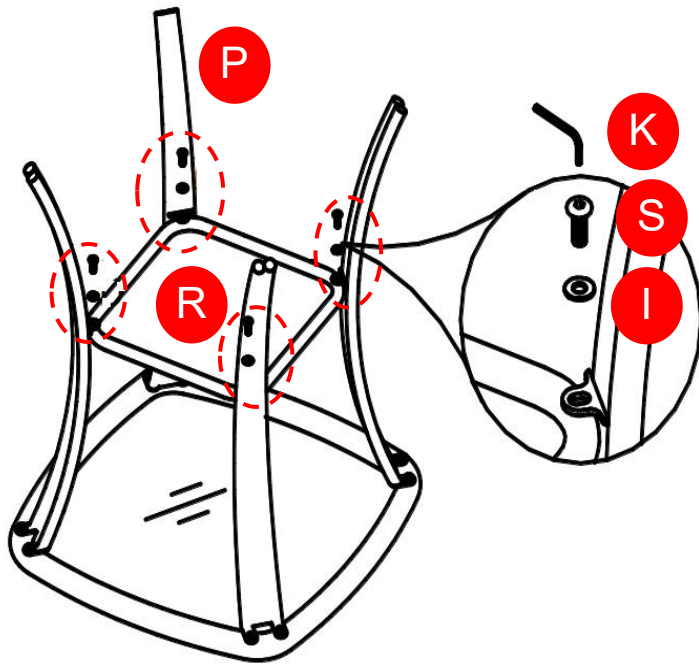

STEP 3

Turn over the assembled table. Verify the alignment and adjust, fully tighten all screws.

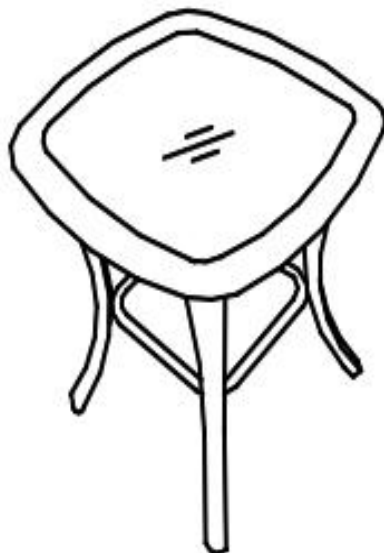

Warranty

One year limited warranty.

Proof of purchase (dated register receipt) is required for warranty claims.

It remains the customer's responsibility for freight and packing charges to and from the service center.