

ASSEMBLY AND USE INSTRUCTIONS

IMPORTANT SAFETY INSTRUCTIONS

When use electrical products, basic precautions should always be followed including the following

READ AND FOLLOW ALL SAFETY INSTRUCTIONS

- For indoor and outdoor use. Do not use seasonal products outdoors unless marked suitable for indoor and outdoor use. When products are used in outdoor applications, connect the product to a Ground Fault Circuit Interrupting (GFCI) OUTLET. If one is not provided, contact a qualified electrician for proper Installation.
- This seasonal use product is not intended for permanent installation or use.
- Do not mount or place near gas or electric heaters, fireplaces, candles, or other similar sources of heat.
- Do not secure the wiring of the product with staples or nails.
- Do not let lamps rest on supply cord or any wire.
- Unplug the product when leaving the house, when retiring for the night, or if left unattended.
- **This is an electric product-NOT a toy! To avoid risk of fire, burns, personal injury and electric shock, it should not be played with or placed where children can reach it.**
- Do not use this product for other than its intended use.
- Do not cover the product with cloth, paper or any material not part of the product when in use.
- This product employs overload protection(fuse). A blown fuse indicates an overload or short-circuit situation. If the fuse blows, unplug the product from the outlet. Also unplug any additional strings or products that may be attached to the product. Replace the fuse as per the user servicing instructions(follow product marking for proper fuse rating) and check the product. If the replacement fuse blows, a short-circuit may be present and the product shall be discarded.
- Do not close doors or windows on the product or extension cords as this may damage the wire insulation.
- Read and follow all instructions that are on the product or provided with the product.

SAVE THESE INSTRUCTIONS

Use and Care Instructions

- 1) Before using or reusing, inspect product carefully, Discard any products that have cut, damaged, or frayed wire insulation or cords, cracks in the lamp holders or enclosures, loose connections, or exposed copper wire.
- 2) When not in use, store neatly in a cool, dry location protected from sunlight.

ASSEMBLY AND USE INSTRUCTIONS

Assembly instruction:

1. Take the wreath and accessory parts out of the box, lay them flat on the floor, and start assembling.
2. Stand up the wreath and fasten the pin of support to the sleeve position on the back of the wreath. As shown in figures 1 and 2.
3. Hang the red bow on a wreath with the support frame. As shown in figures 3.
4. When the product is decorated in outdoors, 3PCS metal stakes are inserted into the soil to fix the product. Tidy the product aesthetic appearance. Plug in 120V power. As shown in figures 5.

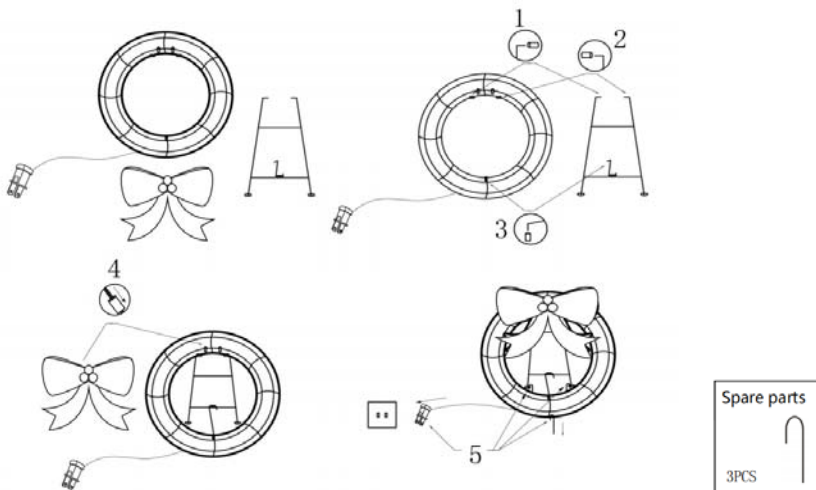

FCC Warning:

Warning: Changes or modifications to this unit not expressly approved by the party responsible for compliance could void the user's authority to operate the equipment."

NOTE: This equipment has been tested and found to comply with the limits for a Class B digital device, pursuant to Part 15 of the FCC Rules. These limits are designed to provide reasonable protection against harmful interference in a residential installation. This equipment generates, uses and can radiate radio frequency energy and, if not installed and used in accordance with the instructions, may cause harmful interference to radio communications.

However, there is no guarantee that interference will not occur in a particular installation. If this equipment does cause harmful interference to radio or television reception, which can be determined by turning the equipment off and on, the user is encouraged to try to correct the interference by one or more of the following measures:

Reorient or relocate the receiving antenna.

Increase the separation between the equipment and receiver.

Connect the equipment into an outlet on a circuit different from that to which the receiver is connected.

Consult the dealer or an experienced radio/TV technician for help.

This device complies with Part 15 of the FCC Rules. Operation is subject to the following two conditions:

- (1) this device may not cause harmful interference, and
- (2) this device must accept any interference received, including interference that may cause undesired operation.

ITEM#: JU23-19

The responsible party contact information is as below:

Company: Big Lots Stores Inc.

<https://www.biglots.com>

Address: 4860 East Dublin-Granville Rd. Columbus, OH 43081-7650, USA

IMPORTANT SAFETY INSTRUCTIONS

When use electrical products, basic precautions should always be followed including the following:

READ AND FOLLOW ALL SAFETY INSTRUCTIONS

- Do not use seasonal products outdoors unless marked suitable for indoor and outdoor use. When products are used in outdoor applications, connect the product to a Ground Fault Circuit Interrupting (GFCI) OUTLET. If one is not provided, contact a qualified electrician for proper installation.
- This seasonal use product is not intended for permanent installation or use.
- Do not mount or place near gas or electric heaters, fireplaces, candles, or other similar sources of heat.
- Do not secure the wiring of the product with staples or nails.
- Do not let lamps rest on supply cord or any wire.
- Unplug the product when leaving the house, when retiring for the night, or if left unattended.
- This is an electric product-NOT a toy! To avoid risk of fire, burns, personal injury and electric shock, it should not be played with or placed where children can reach it.**
- Do not use this product for other than its intended use.
- Do not hang ornaments or other objects from cord, wire, or light string.
- Do not close doors or windows on the product or extension cords as this may damage the wire insulation.
- Do not cover the product with cloth, paper or any material not part of the product when in use.
- This product is equipped with push-in type lamps. Do not twist lamps.
- This product employs overload protection (fuse). A blown fuse indicates an overload or short-circuit situation. If the fuse blows, unplug the product from the outlet. Also unplug any additional strings or products that may be attached to the product. Replace the fuse as per the user servicing instructions (follow product marking for proper fuse rating) and check the product. If the replacement fuse blows, a short-circuit may be present and the product shall be discarded.
- Read and follow all instructions that are on the product or provided with the product.

SAVE THESE INSTRUCTIONS

Use and Care Instructions

- When the product is placed on a live tree, the tree should be well maintained and fresh. Do not place on live trees in which the needles are brown or break off easily. Keep the tree holder filled with water.
- If the product is placed on a tree, the tree should be well secured and stable.
- Before using or reusing, inspect product carefully. Discard any products that have cut, damaged, or frayed wire insulation or cords, cracks in the lampholders or enclosures, loose connections, or exposed copper wire.
- When storing the product, carefully remove the product from wherever it is placed, including trees, branches, or bushes, to avoid any undue strain or stress on the product conductors, connections, and wires.
- When not in use, store neatly in a cool, dry location protected from sunlight.

User Servicing Instructions

Replace the fuse:

- Grasp plug and remove from the receptacle or other outlet device. Do not unplug by pulling on cord.
- Open fuse cover. Slide open fuse access cover on top of attachment plug towards blades.
- Remove fuse carefully.
- Risk of fire. Replace fuse only with 3 Amp, 125 Volt fuse (provided with product).
- Close fuse cover. Slide closed the fuse access cover on top of attachment plug.
- Risk of fire. Do not replace the attachment plug. Contains a safety device (fuse) that should not be removed. Discard product if the attachment plug is damaged.

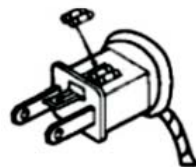

Replace the lamp:

- Grasp plug and remove from the receptacle or other outlet device. Do not unplug by pulling on cord.
- Pull lamp and plastic base straight out of lampholder.
- Replace lamp with 2V 0.04W and 3V 0.06W lamps only. (provided with product).

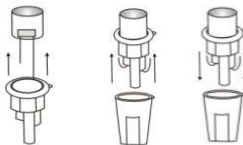

If the new lamp base does not fit in lampholder, follow the steps below before step 3:

- Remove the lamp base of burned out lamp by straightening lamp leads and gently pull lamp out.
- Thread leads of new lamp through holes in old base with one lead in each hole.
- After lamp is fully inserted into base, bend each lead up, like other lamps in the light set so that the leads will touch the contacts inside the lampholder.

If connecting to a lighting string that does not have a Wattage (W) rating { found on the tag within 6 inches of the plug } calculate the wattage as follows:

Multiply the current which is on the flag-type tag by 120.

For Example: Lighting string is rated 120 V, 60 Hz 0.2 Amps. $0.2 \times 120 = 24$ Watts Add the wattage of each light string together for a total of 216 Watts or less. (Do not exceed 216 watts)

CAUTION:

- Risk of fire, This product does not contain lamp shunts, which allow the product to operate if one lamp burns out, Replace lamps only with the spare lamps provided with this product.**
- To reduce the risk of fire and electric shock: a) Do not install on trees having needles, leaves or branch coverings of metal or materials which look like metal. b) Do not mount or support strings in a manner that can cut or damage wire insulation.**

Model No.: JU23-19

Rating: 120V, 60Hz, 0.02A, 2.4W

For indoor and outdoor use

Made In China