

| | | | |
|-----------------------------|-----------------------------|------|-----------|
| BIG LOTS - 2023 CMAS (D360) | | | |
| VENDOR NAME | FAIRTON | SKU# | 810614260 |
| DESCRIPTION | X - 4FT TURQUOISE BLUE TREE | MFG# | FA40-008T |
| ISSUE DATE | 2023/03/21 | | |
| REVISE DATE | | | |
| DESIGNER | Wendy Lai | | Dieline |

ASSEMBLY AND SHAPING INSTRUCTION

WARNING:

1. Read all instructions and warning tags included with this tree. Retain for future reference.
2. Ensure all packaging is removed before assembly and use.
3. Keep tree's light sets unplugged from power before beginning assembly.
4. Keep wires clear of being pinched or cut during assembly and use.
5. Ensure final assembly is upright and stable.
6. Do not use candles on tree.
7. Do not use near candles, fireplaces, radiators, or other similar sources of heat.
8. Do not use near tubs, sinks, or other wet areas.
9. Artificial trees are made from small fibers that may pose a choking hazard if detached from the branches.
Use care around children and pets.

Before you start:

These instructions will guide you on how to set up your tree to ensure it is fully functioning and looking its best. This guide will also give you tips on how to store your tree to last for years to come. Please read the following instruction carefully before you start.

Remember to save the carton for storage of your tree

1. Each tree section contains a tag labeled A and B. Please identify all sections before assembling.
2. Remove the tree sections from the packaging before beginning and keep the carton for future storage. Be sure to save the replacement light bulbs and fuses.
3. Select an area where the ground is firm enough to hold the tree upright.
4. Take out the tree stand, unfold it, and insert the eye bolts. Remove the packing materials from the end of poles. Put the bottom section pole into the tree stand and make sure it is inserted properly as in Fig.1.
5. Continue by inserting the upper tree section into the lower section until inserting the tree top. Make sure the tree is stable and upright. Tighten eye bolts evenly to ensure tree does not lean too far to one side.
6. To connect the light strings, find the power cord at the bottom sections as seen in Fig.2. Connect the electrical cord at the base of tree into a standard electrical outlet or other power sources.
7. To shape the tree please refer to Fig.3. All hinged branches should fall into lower position during assembly. Any branches that remain upright should be gently lowered by hand.
8. Work bottom to top, shaping the branches. Starting with tips closest to the pole, shape one tip to the right, one to the left and one at the center of the main stem. Repeat pattern for each branch in Fig.4.

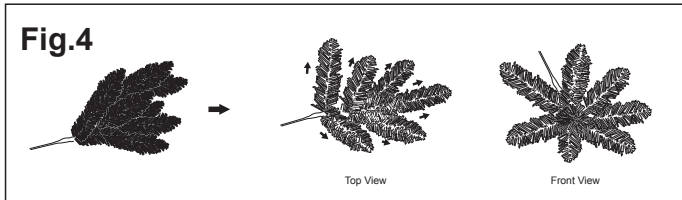
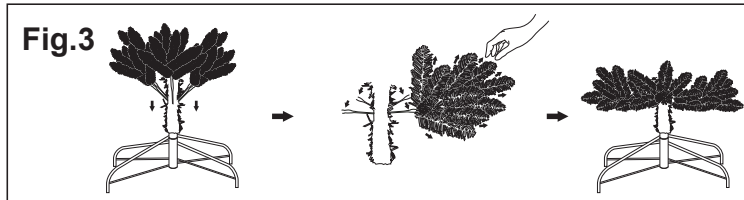

1

29.7 cm

IMPORTANT SAFETY INSTRUCTIONS

When using electrical products, basic precautions should always be followed including the following:

a) READ AND FOLLOW ALL SAFETY INSTRUCTIONS.

- b) This product is for indoor use only. The electrical rating 0.34 A 120 V 60 Hz.
- c) Do not use seasonal products outdoors unless marked suitable for indoor and outdoor use. When products are used in outdoor applications, connect the product to a Ground Fault Circuit Interrupting (GFCI) outlet. If one is not provided, contact a qualified electrician for proper installation.
- d) This seasonal use product is not intended for permanent installation or use.
- e) Do not mount or place near gas or electric heaters, fireplace, candles or other similar sources of heat.
- f) Do not secure the wiring of the product with staples or nails, or place on sharp hooks or nails.
- g) Do not let lamps rest on the supply cord or on any wire.
- h) Unplug the product when leaving the house, or when retiring for the night, or if left unattended.
- i) This is an electric product – not a toy! To avoid risk of fire, burns personal injury and electric shock it should not be played with or placed where small children can reach it.
- j) Do not use this product for other than its intended use.
- k) Do not hang ornaments or other objects from cord, wire, or light string.
- l) Do not close doors or windows on the product or extension cords as this may damage the wire insulation.
- m) Do not cover the product with cloth, paper or any material not part of the product when in use.
- n) Do not move the tree by pulling the tree tips or tree branches.
- o) Read and follow all instructions that are on the product or provided with the product.

Troubleshooting Instructions:

If lights do not work...

1. Make sure the lights are plugged in, and the outlet they are connected to has power.
2. Check whether all bulbs are tightly fixed into the bulb socket.
3. If a bulb is blown, replace the faulty bulb following the diagram.
There are spare bulbs included for easy replacement. Keep the light strands unplugged from power before replacement.

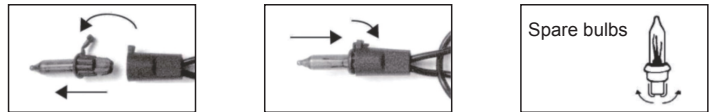

4. If none of the lights are working in a section, check the fuse in the light strand plug. If the fuse is blown, replace the blown fuse following the diagram. There are spare fuses included for easy replacement. Make sure to check both fuses. Keep tree's light strands unplugged from power before replacement.

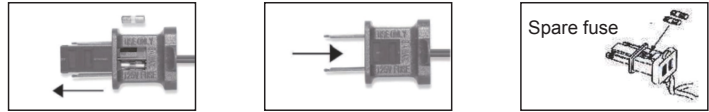

STORAGE TIPS

- Unplug the plug of light string from the wall outlet.
- Work top to bottom. Pressing branches against stem.
- Place tree into carton.
- Store carton away from heat in a cool and dry place.

DO NOT STORE TREE IN A DAMP AREA OR IN AN AREA WHERE THE TEMPERATURE EXCEEDS 100 F.

PVC NEEDLE FLAME RETARDANT
FOR INDOOR USE ONLY
THIS IS NOT A TOY. FOR DECORATIVE USE ONLY.
MADE IN CHINA

Need a help? Please contact us.

Big Lots Stores, Inc.
P.O. Box 28523; Columbus, OH 43228-0523
TEL:1-866-244-5678

2