

CLIMATE KEEPER®

CLIMATE KEEPER®

16 IN. OSCILLATING STAND FAN

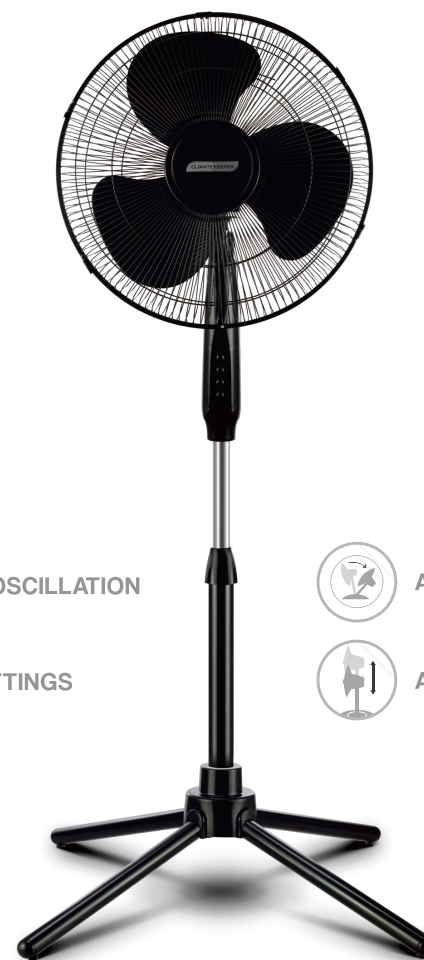

90 DEGREE OSCILLATION



ADJUSTABLE TILT



3 SPEED SETTINGS





ADJUSTABLE HEIGHT



USER GUIDE

INSTRUCTION FOR USE

 To avoid damage due to incorrect use, please read through these Operating Instructions carefully before connecting your device to an electrical outlet. Please pay particular attention to the safety information. If you pass the device to a third party, these Operating Instructions must also be handed over.

 **WARNING** When using any electrical appliance, basic safety precautions should always be followed to reduce the risk of fire, electrical shock and personal injury.

SAFETY INFORMATION

 **Incorrect operation and improper handling can lead to damage to the device and injuries to the user. READ ALL INSTRUCTIONS.**

Use the appliance on a flat, dry surface

Do not store or operate the appliance in the open air.

Never put fingers or any other objects through the grilles (fan guards) when the fan is running.

Keep the appliance away from damp areas, and open water.

Keep the appliance away from hot objects (e.g. hotplates) and open flames.

The appliance must be assembled completely before use.

Keep small children away from the appliance.

WARRANTY

This unit is guaranteed to the original retail purchaser against defects in quality or workmanship for a period of one year from the date of original purchase. If this unit fails because of a manufacturing defect within 30 days of purchase, return the unit, with your receipt, to the retailer. After 30 days, but within the warranty period, if the unit was purchased within the continental United States, return it, freight prepaid, to Big Lots for repair or replacement. If the unit was purchased outside the continental United States, return the unit to the place of purchase. This warranty does not cover damage caused by misuse, abuse, overheating or alteration. Repairs made by anyone other than Big Lots are not covered in this warranty. Big Lots will not be held liable for any losses due to neglectful operation. All implied warranties, including the warranties of merchantability and of fitness of purpose, if applicable, are hereby limited in duration to the period of one year from the date of original retail purchase. Some states do not allow limitations on how long an implied warranty lasts, so the above limitations may not apply to you. Incidental or consequential damages arising from a breach of either express or implied warranties are hereby disclaimed and excluded. Some states do not allow the exclusion of limitation of incidental or consequential damages, so this limitation or exclusion may not apply to you. Upon the expiration of this warranty all such liability will terminate. No other warranties are expressed or implied.

This warranty gives you specific legal rights, and you may also have other rights which vary from state to state. No informal dispute settlement mechanisms are available. This limited warranty is given in lieu of all other warranties.

Manufactured for:

Big Lots Stores, Inc.

P.O. Box 28523; Columbus, OH 43228-0523

Rev. 296018

OPERATING INSTRUCTIONS

1. Plug the power cord into a suitable outlet.
2. Oscillation: To make the fan head oscillates, push down the Oscillation Knob. To stop the fan head from oscillating, pull-up the Oscillation Knob.
3. The fan is switched on using the push buttons on the control panel, i.e. 0: Off, 1 = Low Speed, 2 = Medium, Speed 3=high speed.

CAUTION: Press only one of the speed control button at a time. Permanent damage to the switch housing may result if two or more of the buttons are pressed simultaneously.

TECHNICAL DATA

- **Operating voltage:** 120V ~ 60Hz
- **Power consumption:** 50W

CLEANING

- Before servicing the fan and after each occasion of use, switch off the appliance and unplug the mains cable from the socket.
- **Never immerse the appliance in water (danger of short-circuit).** To clean the appliance, only wipe it down with a damp cloth and then dry it carefully. Always take out the mains plug first.
- Take care that excessive dust does not build up in the air-intake and air-outlet grille, and clean it occasionally using a dry brush or vacuum cleaner.

ENVIRONMENT FRIENDLY DISPOSAL



You can help protect the environment!
Please remember to respect the local regulations: dispose of the non-working electrical equipment to an appropriate waste disposal center.

Never leave the device unattended during use.

Store the appliance in a dry place, inaccessible to children.

Never remove the plug from the outlet by pulling on the cord, or with wet hands.

Be careful with long hair which can be caught in the fan from behind the device.

Ensure that the wire does not hang over sharp edges or allow it to become trapped.

In the event of improper use or incorrect handling, no liability can be accepted for any damage that may occur.

Before you put the plug into an outlet, please check that the electrical current and voltage correspond to the instructions on the nameplate on the underside of the appliance.

Do not immerse the unit or plug in water or other liquids. There is danger to life due to electric shock! However, if this should occur, remove immediately and ave the unit checked by an expert before using it again.

Do not operate the device if the cord or the plug show signs of damage, or if the device has otherwise been damaged. In such cases take the device to a specialist for checking and repair, if necessary.

Never operate the product without the grilles (fan guards) in place, as serious personal injury may result.

If the supply cord is damaged, it must be replaced by the manufacturer, service agent or similarly qualified persons.

Ensure that the fan is unplugged before removing the guard.

ASSEMBLING & OPERATING INSTRUCTIONS

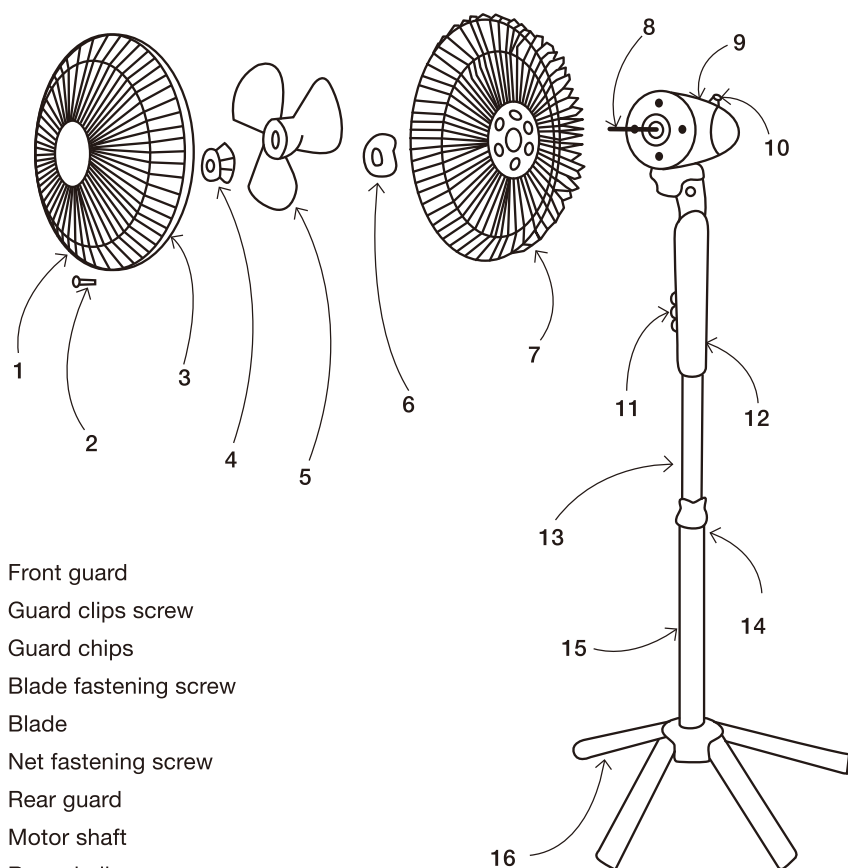

1. Front guard
2. Guard clips screw
3. Guard chips
4. Blade fastening screw
5. Blade
6. Net fastening screw
7. Rear guard
8. Motor shaft
9. Rear shell
10. Oscillation button
11. Speed switch
12. Fastening screw
13. Height adjustment pipe
14. Fasten set
15. Standing shaft
16. Standing base

PLEASE ASSEMBLE CORRECTLY BY THE FOLLOWING INSTRUCTIONS WHEN USING.

STAND

- Put the standing shaft on the standing base.
- Screw the standing shaft on the standing base.

THE WHOLE BODY

- Pull the height adjustment pipe out and tighten the fasten set.
- Link the fan main body and the height adjustment pipe together by the fastening screw and tighten.

REAR GRILLE

- Screw the blade fastening screw out in clockwise direction and screw the guard fastening screw out in the counter-clockwise direction.
- Fix the rear guard onto the two pillars of the motor front shell.
- Screw the guard fastening screw tightly in clockwise direction

FAN BLADE

- Insert fan blade onto shaft ensuring blade fits properly onto grooves on shaft.
- Tighten blade screw onto shaft. Note: Blade screw should be tightened in counter-clockwise direction.

FRONT GRILLE

- Put the hook of the front grille on the top of rear grille.
- Attach front grille to rear grille and then close clips and using the appropriate screw to secure grille together.