



4PC KIDS SURFBOARD TABLE & STOOL SET

ASSEMBLY INSTRUCTIONS

ITEM#: KYW-11390B

SKU#: 810587397

Need help? We are here for you!

1-800-935-3959 Toll Free or email us at support@teamson.com

GENERAL BEST PRACTICES FOR ASSEMBLY:

Read all instructions before starting

Clear a flat covered space to begin

Always best to do it with a friend

Note that hardware required is provided for every step

Pay attention to orientation

Letter of the part corresponds to a sticker on the product

Number of the hardware corresponds to its letter in the package

Helpful hints provided along the way

WARNINGS:

Use the correct screws as indicated. All screws should be hand tightened until the complete piece is assembled (This will make the assembly process much easier). Once the piece is fully assembled, then go back and tighten all screws with provided tool. Keep all children and pets away from assembly area. Children and pets should be supervised when they are in the area of the product construction. Keep assembly area at least 6 feet from any obstruction such as a fence, garage, house, overhanging branches, laundry line or electrical wires. Some parts may contain sharp edges.

When assembling and using this product, basic safety precautions should always be followed to reduce the risk of personal injury and damage to the product. Please read all instructions before assembly and use.

The stool and table are not to be used for standing purposes. Use on even surfaces only.

The stool is used at weight of 110lbs (50kgs) and table is used at weight of 66lbs (30kgs). Improper use of this product or failure to use as directed may result in injury. Not intended for commercial use.

MAINTENANCE:

Fabric care:

Hand wash cold, Lay flat to dry, Cool iron if necessary. Do not dry clean

Wood care:

Before using, clean the product completely with a soft dry towel. Screws will be loosened over a period of usage, please check the screws occasionally and re-tighten if necessary.

PARTS LIST

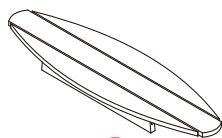

A

x2
Seat



B

x2
Support rail



C

x4
Leg

HARDWARE LIST

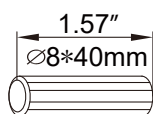

2

x4
Wood bolt

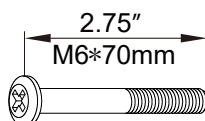

3

x12
Phillips screw



M6

5

x12
Barrel Nut

HELPFUL HINTS

- Tools needed, but not included:

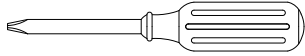
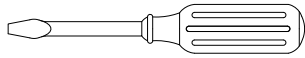

- Separating parts before starting

How to install barrel nuts

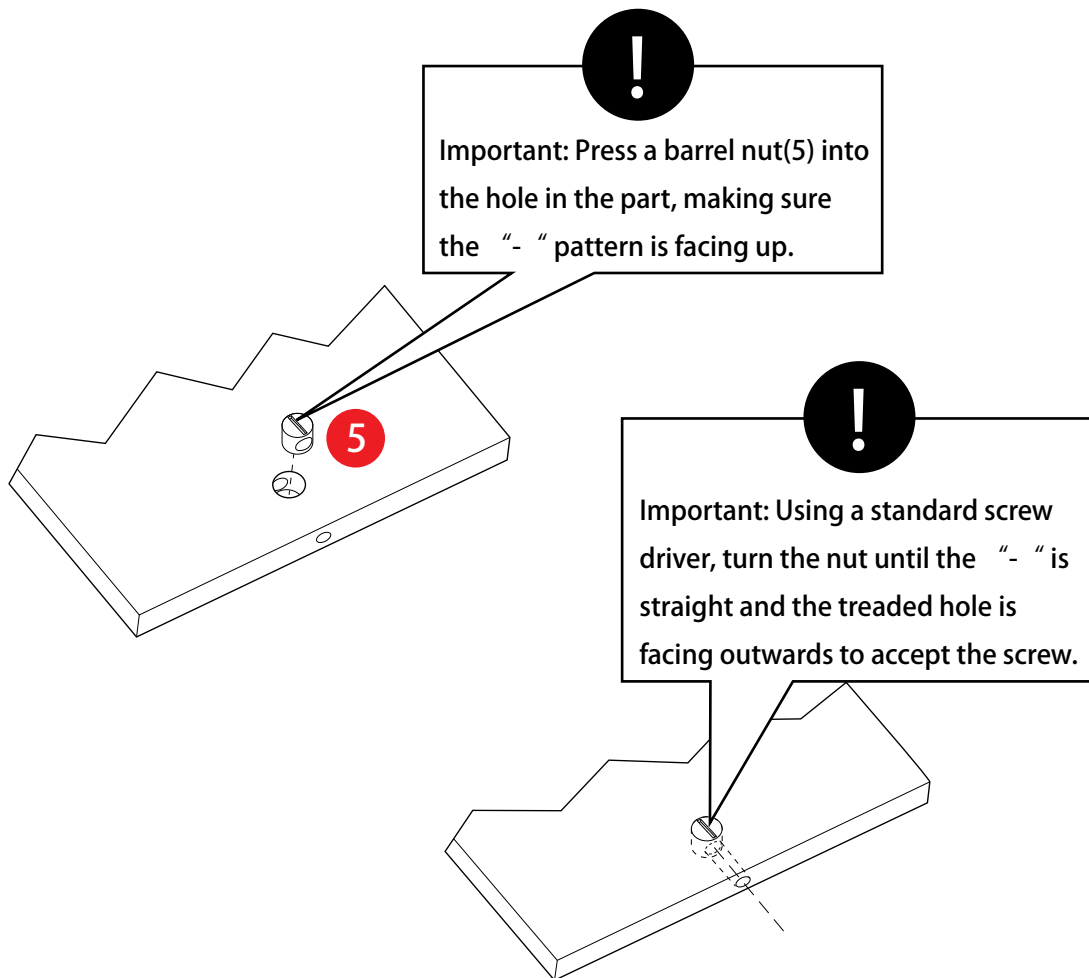

STEP 1

Put 12 x part (5) into the hole of seat (A) and support rail (B), Make sure the "-" of barrel nut is aligned up the hole. Attaching leg to seat and wood support rail with 12 x part (3) and 4 x part (2)

2



∅ 8*40mm
x4

3

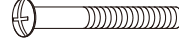

M6*70mm
x12

5



M6
x12

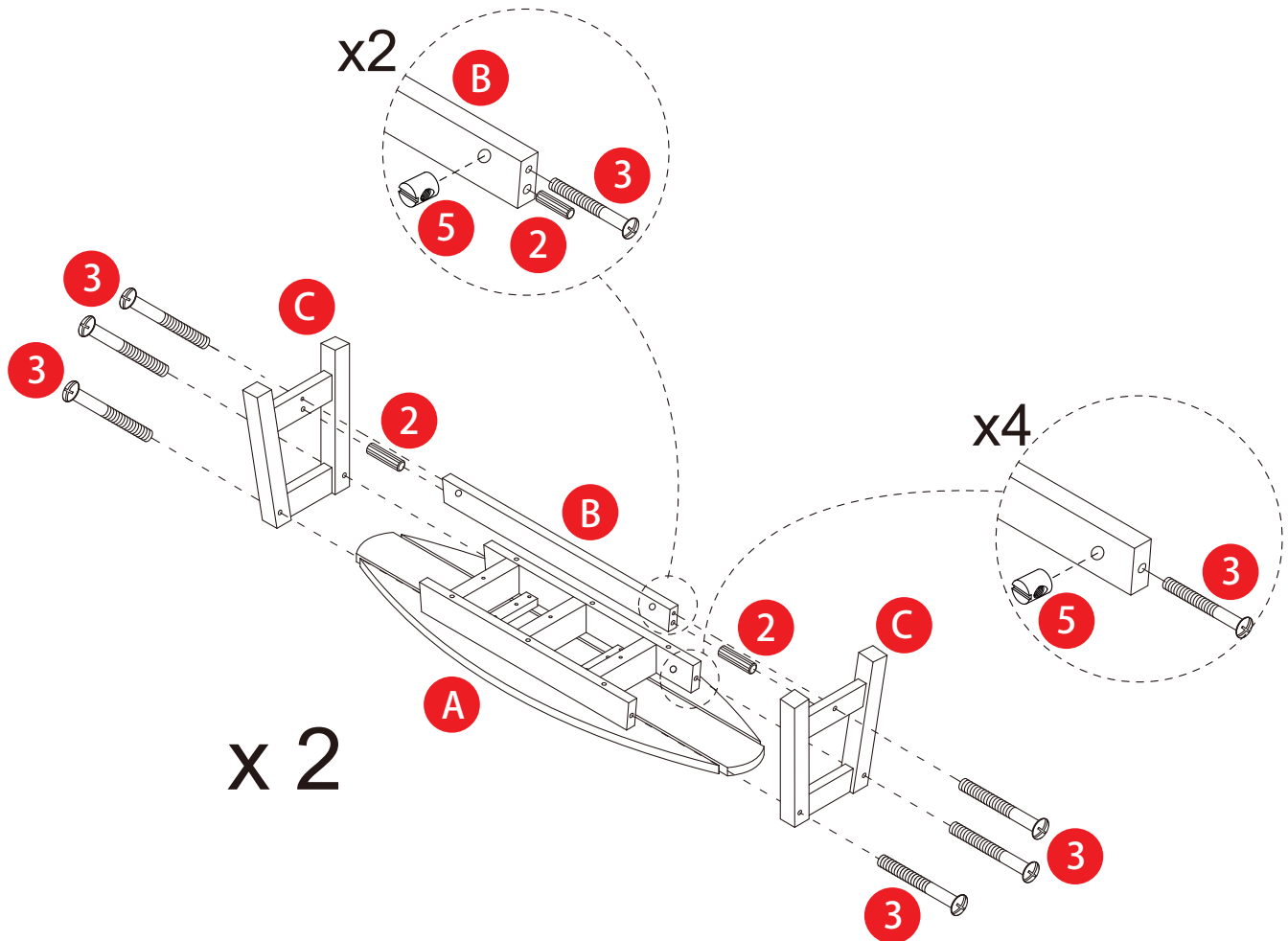

Assembled View: Stool

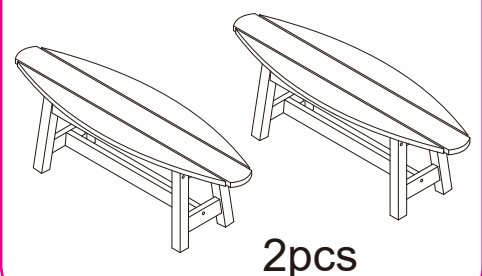

PART LIST

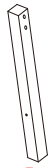

D

x2
Left leg

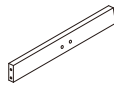

E

x2
Short cross bar



F

x2
Right leg

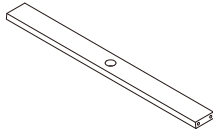

G

x1
Long cross bar

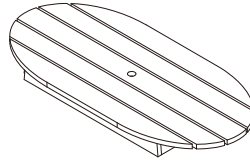

H

x1
Table top



I

x1
Bottom post of umbrella



J

x1
Canopy with upper post of umbrella

HARDWARE LIST

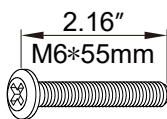

1

x10
Machine screw

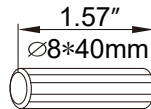

2

x6
Wood bolt

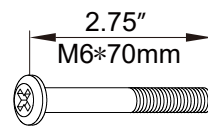

3

x4
Phillips screw



M6

4

x8
Hexagon Nut



M6

5

x6
Barrel Nut

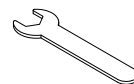

6

x1
Wrench

STEP 2

Put 4 x part (5) into the hole of wood cross bar of table leg (E), Make sure the "-" is aligned up of hole. Attaching right & left leg (D & F) to cross bar (E) with 4 x part (3) and 4 x part (2)

2

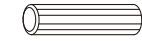

∅ 8*40mm
x4

3

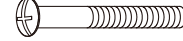

M6*70mm
x4

5



M6
x4

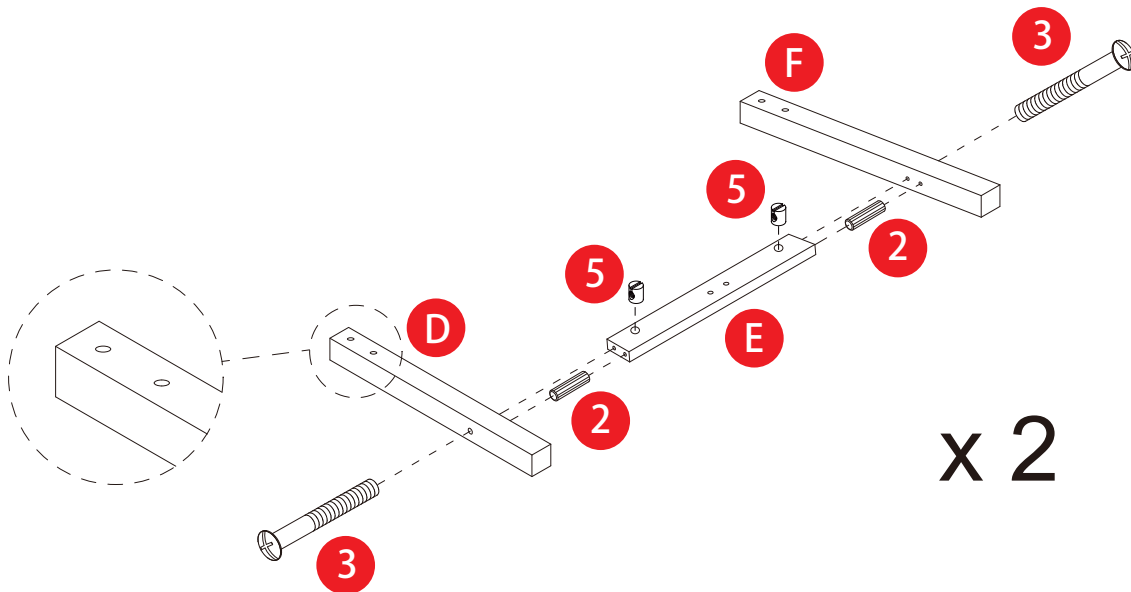

Assembled View:

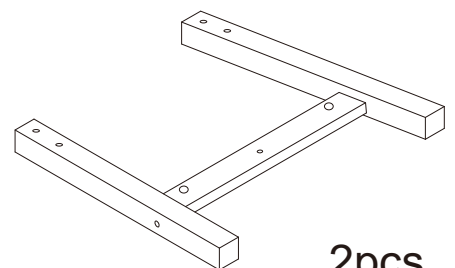

2pcs

STEP 3

Put 2 x part (5) into the hole of long cross bar of table leg (G), Make sure the "-" is aligned up of hole. Attaching assembled right leg and left leg to long cross bar (G) with 2 x part (1) and 2 x part (2)

1



M6*55mm
x2

2



∅ 8*40mm
x2

5



M6
x2

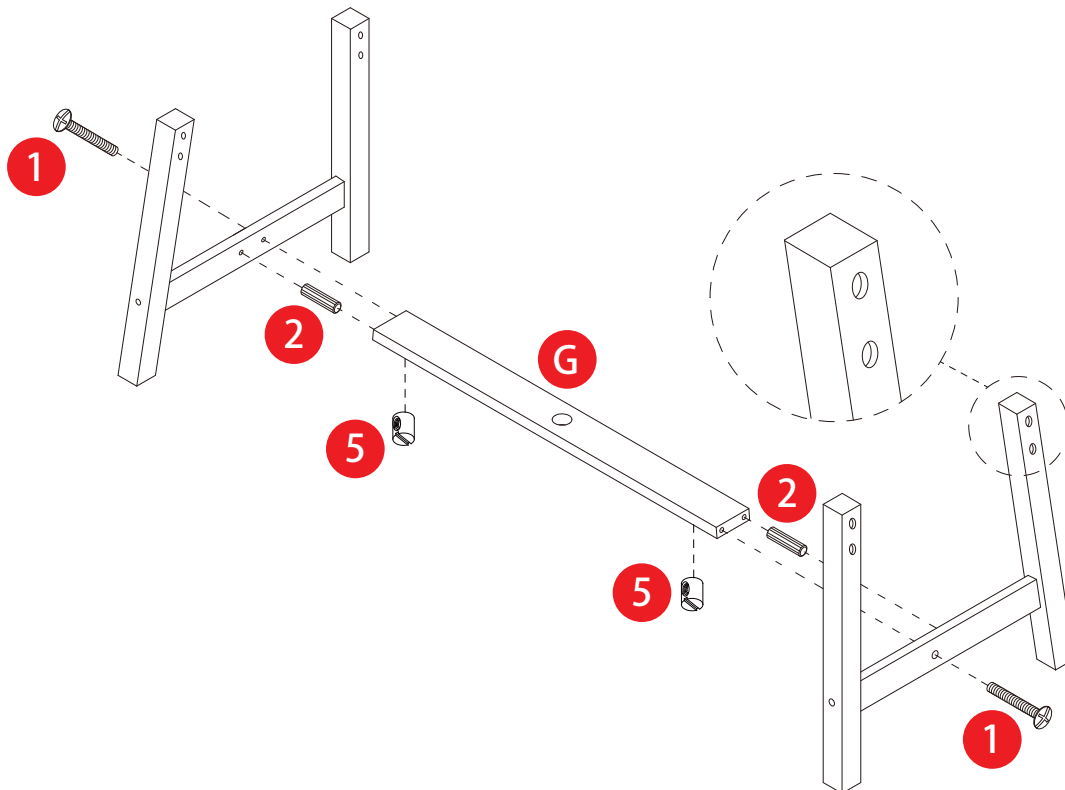

Assembled View:

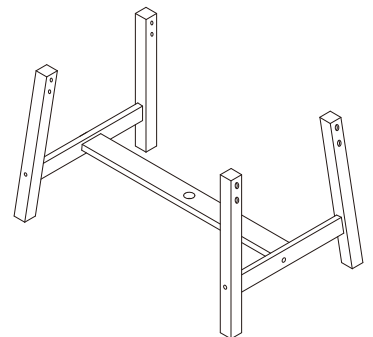

STEP 4

Attaching legs to table top (H) with 8 x part (1) and 8 x part (4) and wrench (6)

1



M6*55mm
x8

4



M6

x8

6

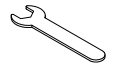

x1

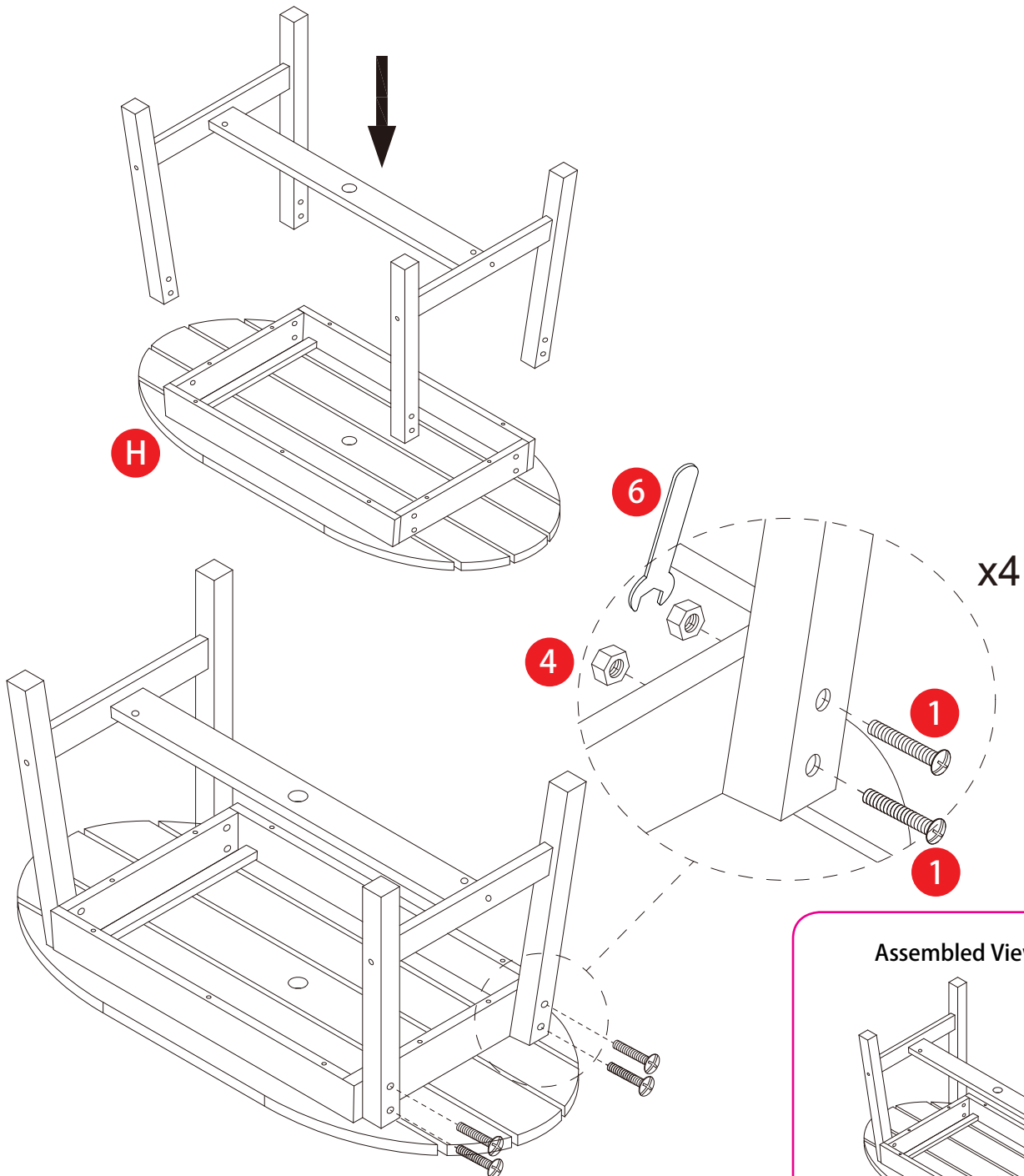

Assembled View: Table

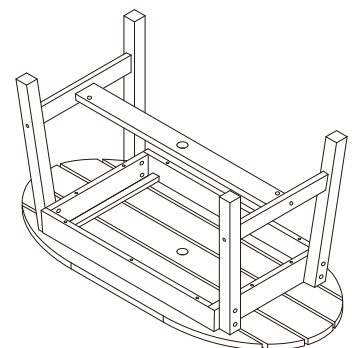

STEP 5

Screwing on the bottom post of umbrella (I) and canopy with upper post of umbrella (J) in clockwise orientation

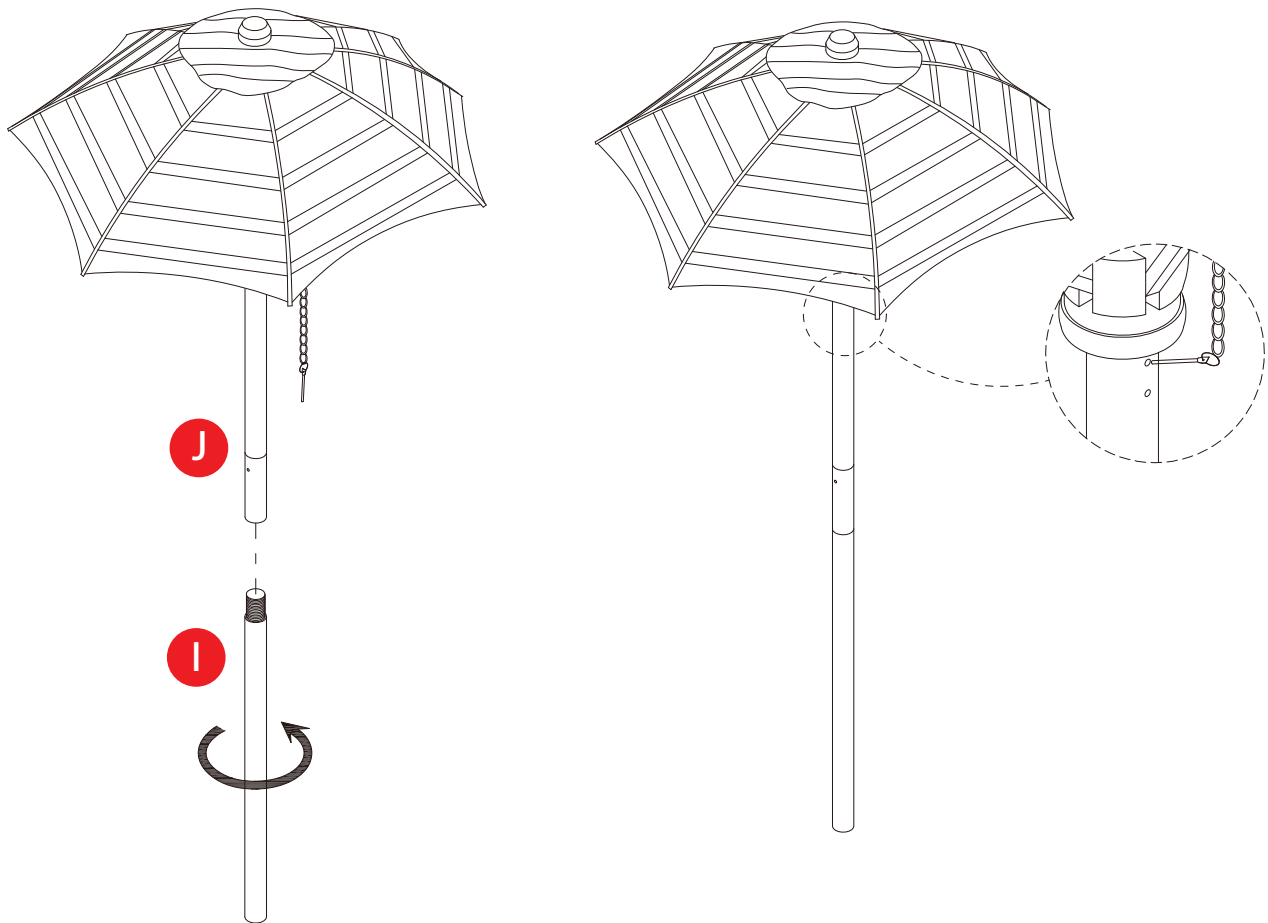

Assembled View:

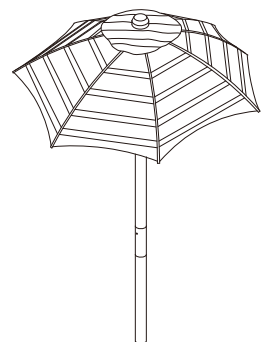

STEP 6



Made in China