

## ASSEMBLY INSTRUCTION

ITEM#: GHP22090

SKU#: 810584310

Made in China



---

# 10 INCH STEEL ROUND TABLEFIRE, 1 lb LP

---

Need help? We are here for you! 1(877)447 - 4768 M-F, 8am - 4:30 pm CST • Toll Free

---

# WARNINGS

---

**⚠ WARNING: If the information in this manual is not followed exactly, a fire or explosion may result causing property damage, personal injury, or loss of life.**

**⚠ DANGER**

## **FIRE OR EXPLOSION HAZARD**

If you smell gas:

- Shut off gas to the appliance.
- Extinguish any open flame.
- If odor continues, leave the area immediately.
- After leaving the area, call your gas supplier or fire department.

Failure to follow these instructions could result in fire or explosion, which could cause property damage, personal injury, or death.

**⚠ WARNING**

Do not store or use gasoline or other flammable vapors and liquids in the vicinity of this or any other appliance. An LP-cylinder not connected for use shall not be stored in the vicinity of this or any other appliance.

**⚠ WARNING: For Outdoor Use Only.**

Installation and service must be performed by a qualified installer, service agency, or the gas supplier.

**⚠ WARNING**

Improper installation, adjustment, alteration, service or maintenance can cause property damage, personal injury or loss of life. Refer to the owner's information manual provided with this appliance. Installation and service must be performed by a qualified installer, service agency, or the gas supplier.

**⚠ DANGER**

## **CARBON MONOXIDE HAZARD**

This appliance can produce carbon monoxide which has no odor.

Using it in an enclosed space can kill you. Never use this appliance in an enclosed space such as a camper, tent, car or home.



**INSTALLER:** Leave this manual with the appliance. **CONSUMER:** Retain this manual for future reference.

---

# SAFETY INFORMATION

---

Before you assemble or operate this unit, please carefully read this entire manual. Failure to do so **may result in a fire, explosion, injury or death.**

- The installation of this unit must adhere to local codes or Propane Storage and Handling Code, CSA B149.2.
- **THIS UNIT IS INTENDED FOR OUTDOOR USE ONLY!** This product shall be used outdoors, in a ventilated space and shall not be used in any enclosed area.
- This unit is to be used with propane gas only! (sold separately)
- Do not attach a remote gas supply to this unit.
- Only use propane gas for this unit.
- Solid fuels shall not be burned in this appliance.
- **LP GAS WARNING:** Do not use any more than 1/4in depth lava rocks/pumice stones/LavaGlass® above the burner.
- If the propane gas tank is leaking gas, you may hear, see, or smell a hiss. Do the following:
  1. Disconnect the propane gas tank.
  2. Do not attempt to fix the problem yourself.
  3. Contact your propane gas supplier or fire department for help.
- Applying too much propane may result in gas pooling and will not burn. Allow fresh air into the unit so that the remaining gas may escape.
- Do not use a flame to check for gas leaks.
- The maximum gas supply: 250 psi; Min. gas supply: 10 psi
- This appliance is designed for use with a 16.40Z (1Lb) propane gas cylinder (disposable).
- **DO NOT** fill tank over 80% full.
- The tank system must be set up for vapor withdrawal.
- Discontinue use if any part of the propane tank is damaged. Rust and dents may be hazardous and should be inspected by a propane gas supplier.
- Do not burn anything other than the provided materials for this fire table.
- Keep away from unit for the first 20 minutes after igniting your unit for the first time, as lava rocks/pumice stones/LavaGlass® could popout and cause injury. Should any rocks pop out, discard them.
- Always ensure that lava rocks/pumice stones/LavaGlass® are completely dry before use. Failure to do so will cause them to crack or pop.
- Do not operate unit until all parts are fully assembled.
- Do not paint or color any part of this heating unit.
- Unit may be hot while in use, do not attempt to move it while in use.
- Never leave this heating unit unattended while in use.
- This unit is not intended for cooking.
- Keep any flammable items away and do not use any other fireplace cover for this unit.
- Keep a safe distance to avoid burning skin or clothing.
- Do not sit or rest hands or feet on this heating unit.
- Never place hands or fingers on upper portion of this unit while in use.
- Keep all electrical cords and fuel supply hose away from heated surfaces.
- Cover must be removed when burner is in operation.
- Combustible material should not be within 60 inches of the top of the unit, or within 48 inches around the entire unit and free from combustible material, gasoline and other flammable vapors and liquids.
- If the flame goes out while burning, turn the gas valve off. Wait 5 minutes before repeating the initial lighting procedure. Once you have a flame started, hold down the control knob for 1 minute.
- Do not add water into the unit.
- Do not operate unit if any part has been under water. Immediately call a qualified service technician to inspect the appliance and replace any part of the control system and any gas control that has been under water.
- Do not disconnect any part while unit is in use.
- Do not store a spare propane tank on or near this unit.
- If the heating unit is indoors, detach the propane tank and leave outdoors.
- Do not operate on a boat or vehicle. The unit must be used on a flat surface and outdoors **ONLY**.
- Always remove protective cover before operating (if applicable).
- Do not set the protective cover over the unit until it is turned off and completely cooled down.
- Check for leaks after not using the unit for long periods of time.
- Children should never operate this unit. Children must be supervised while near this unit.
- Keep gas tank at least 5 feet away from unit when lit. (if external tank)
- All installation and repair should be done by a qualified professional. This unit should be inspected annually and cleaned regularly.
- Inspect all elements of this heating unit before each use. If there is damage, the burner must be replaced.
- Keep the hose out from any pathways to eliminate any accidental damage. (if external tank)
- Be aware of the hazards of high temperatures and stay away from the unit to avoid any burns or injury.

---

# SAFETY INFORMATION

---

- The gas supply tank should be constructed and marked with the specifications for the LP gas tanks of the U.S. Department of Transportation or the National Standard of Canada CAN/CSA-B339, LP gas tanks, spheres and tubes for Transportation of Dangerous Goods; and Commission.
- The LP gas tank must have a listed overfilling prevention device and a QCCI or Type I, (CGA791) LP gas tank connection.
- This heating appliance should not be used on plastic or artificial wood decks.
- **Children and adults should be alerted to the hazards of high surface temperatures and should stay away to avoid burns or clothing ignition.**
- **Young children should be carefully supervised when they are in the area of the appliance. near the appliance.**
- **Clothing or other flammable materials should not be hung from the appliance or placed on or near the appliance.**
- **Any guard or other protective device removed for servicing the appliance shall be replaced.**
- **Installation and repair should be done by a qualified service person. The appliance should be inspected before use and at least annually by a qualified service person.**
- **More frequent cleaning may be required as necessary. It is imperative that the control compartment, burners and circulating airways of the appliance are kept clean.**
- Check for leaks after not using the unit for long periods of time.

## IF APPLICABLE:

- Allow heating item to cool completely before placing on lid.
- **DO NOT** use heating item while lid is installed Always remove the lid while heating item is in use.
- Only use the regulator and hose assembly provided with this unit. Replacement parts must be supplied directly by manufacturer.
- Inspect the burner before use of this unit. If the burner shows any kind of damage, do not operate the appliance. For assistance with repair or replacement of the burner or any other parts, call manufacturer at 1.877.447.4768

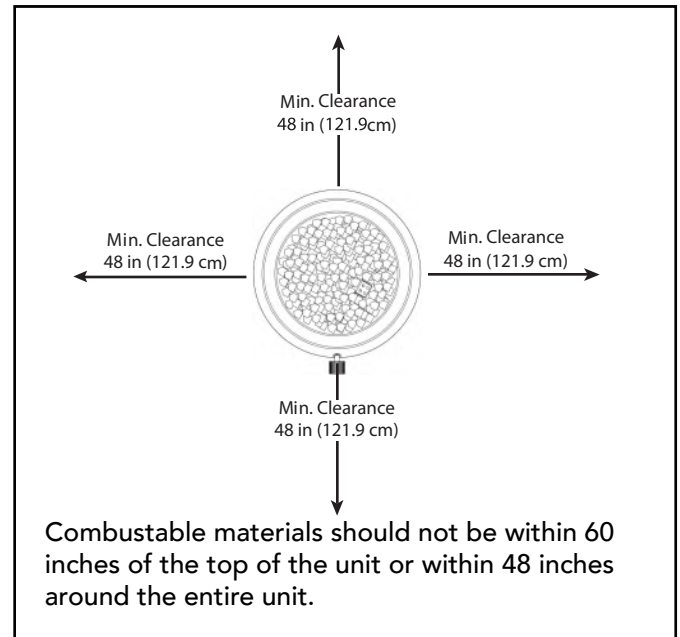

- A table with an umbrella hole (not included) is required to assemble this product.
- The umbrella hole table size needs to meet the following requirements:
- The length and width should not be shorter than 81.28 cm / 32 in.
- The height should be lower than 101.6 cm / 40 in.
- The tabletop should be Non combustable material.

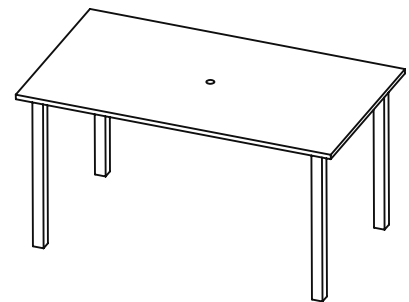

# PARTS LIST

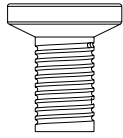

**AA**

x2  
M4 Screw



**BB**

x1  
Wing Screw

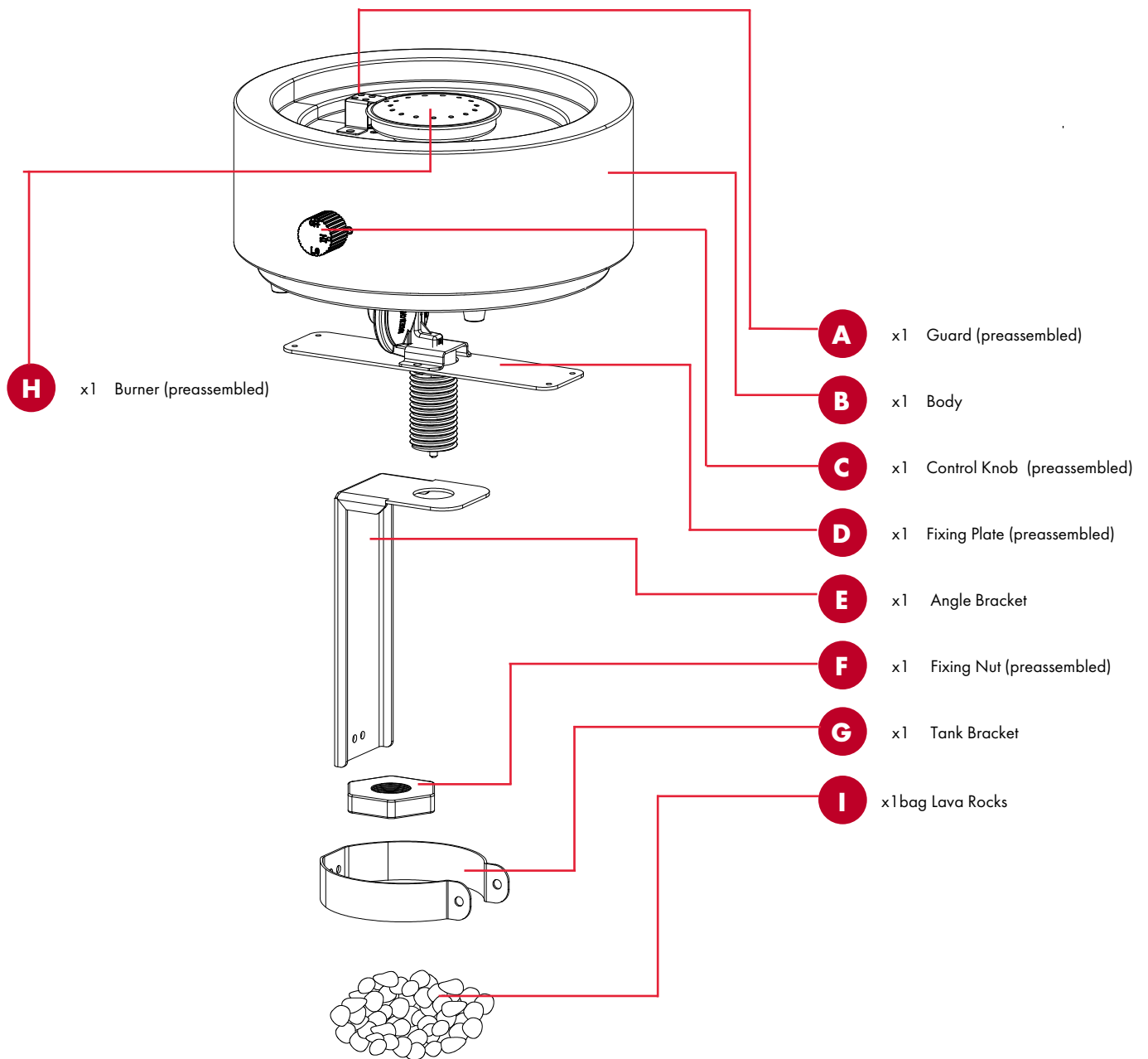

## STEP 1

Unscrew and remove the fixing nut (F) from the threaded post.

F



x1

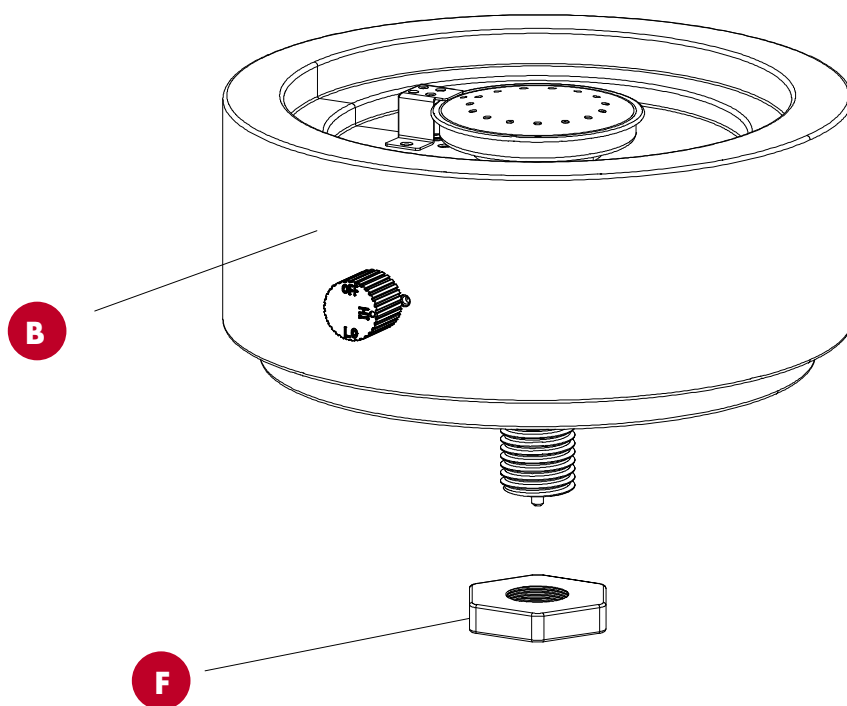

## STEP 2

Attach the tank bracket (G) to angle bracket (E) using 2 M4 screws (AA) .

AA



x2

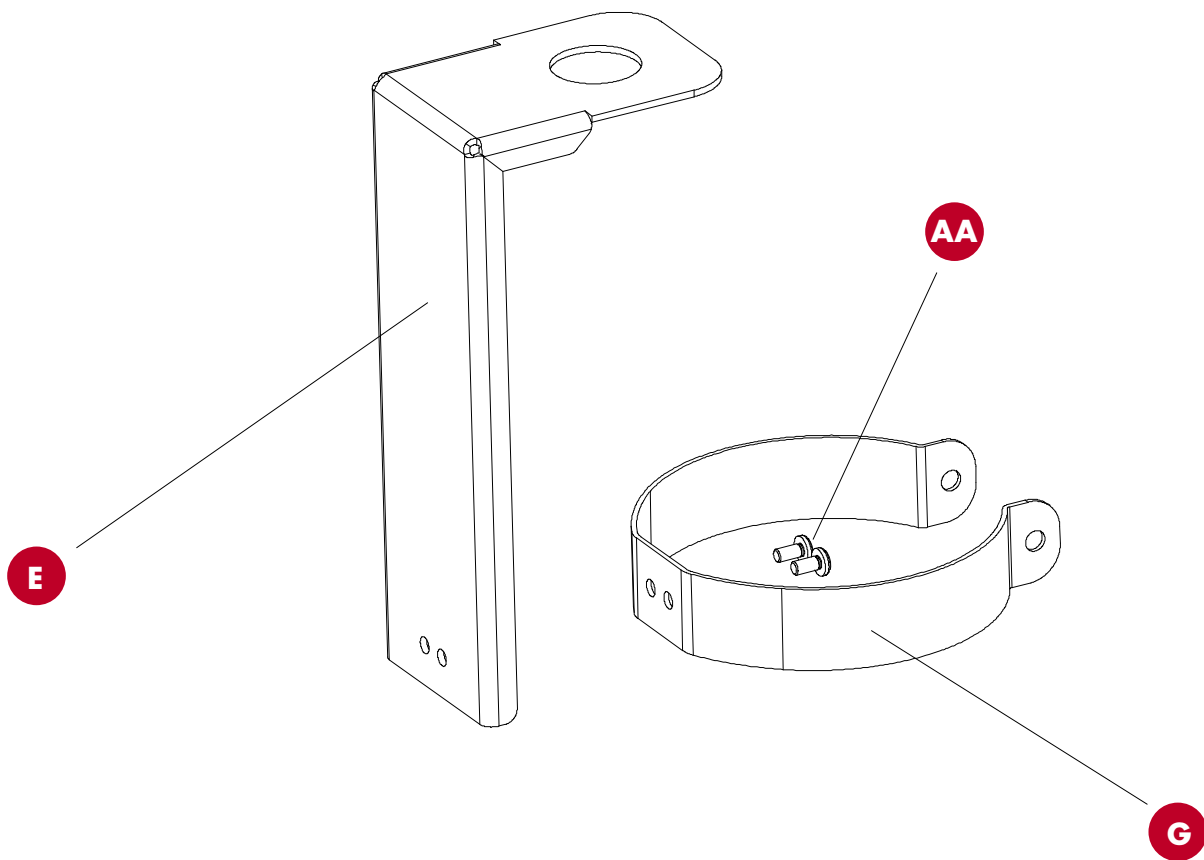

## STEP 3

Insert the body (B) through the umbrella hole in the table and the tank bracket assembly made in step 2. Screw the fixing nut (F) to the body (B) from the underside of the table to secure the body to the table.

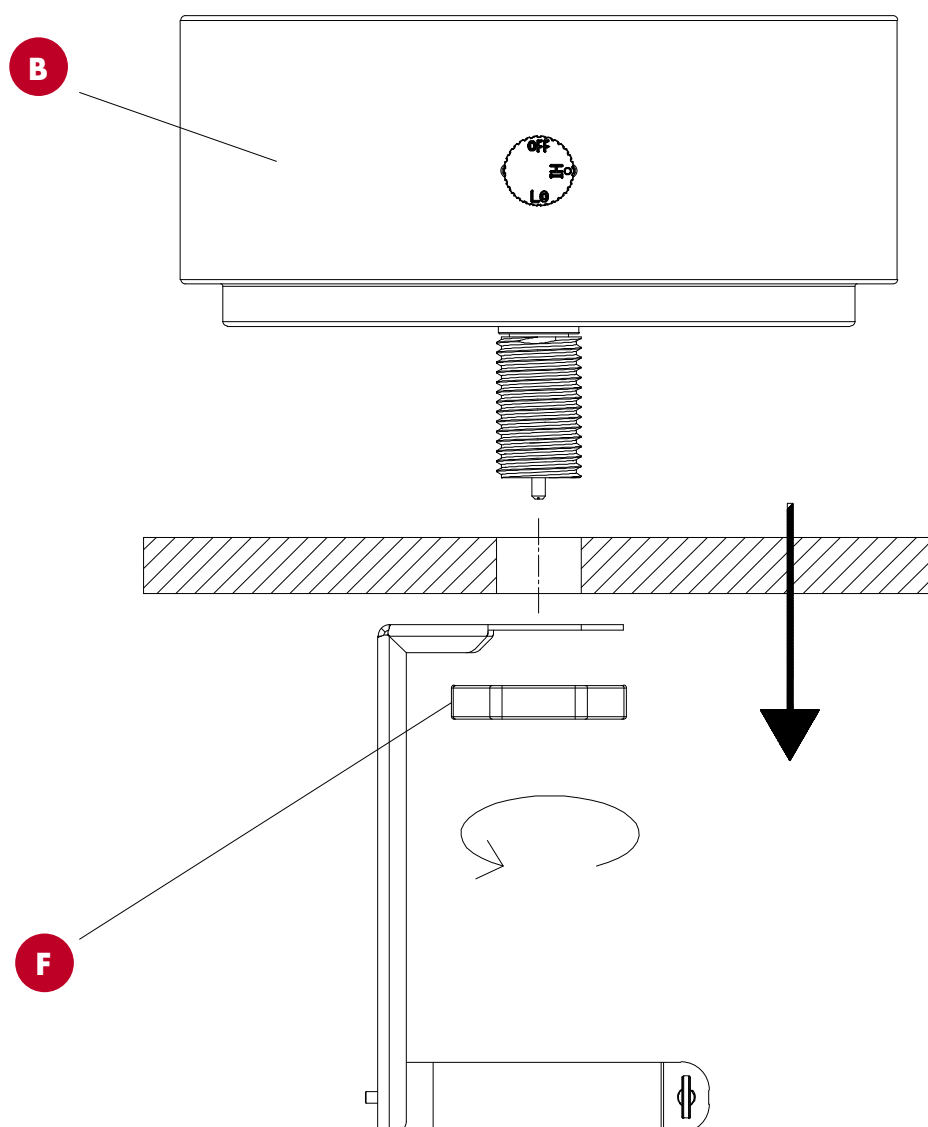



## STEP 4

Check that the control knob (C) for the gas supply system is turned to the "OFF" position before assembling the 1 lb. propane gas tank. .  
To attach the 1 lb. propane gas tank (not included) on the unit, screw the 1 lb. gas tank to the regulator inlet fitting.

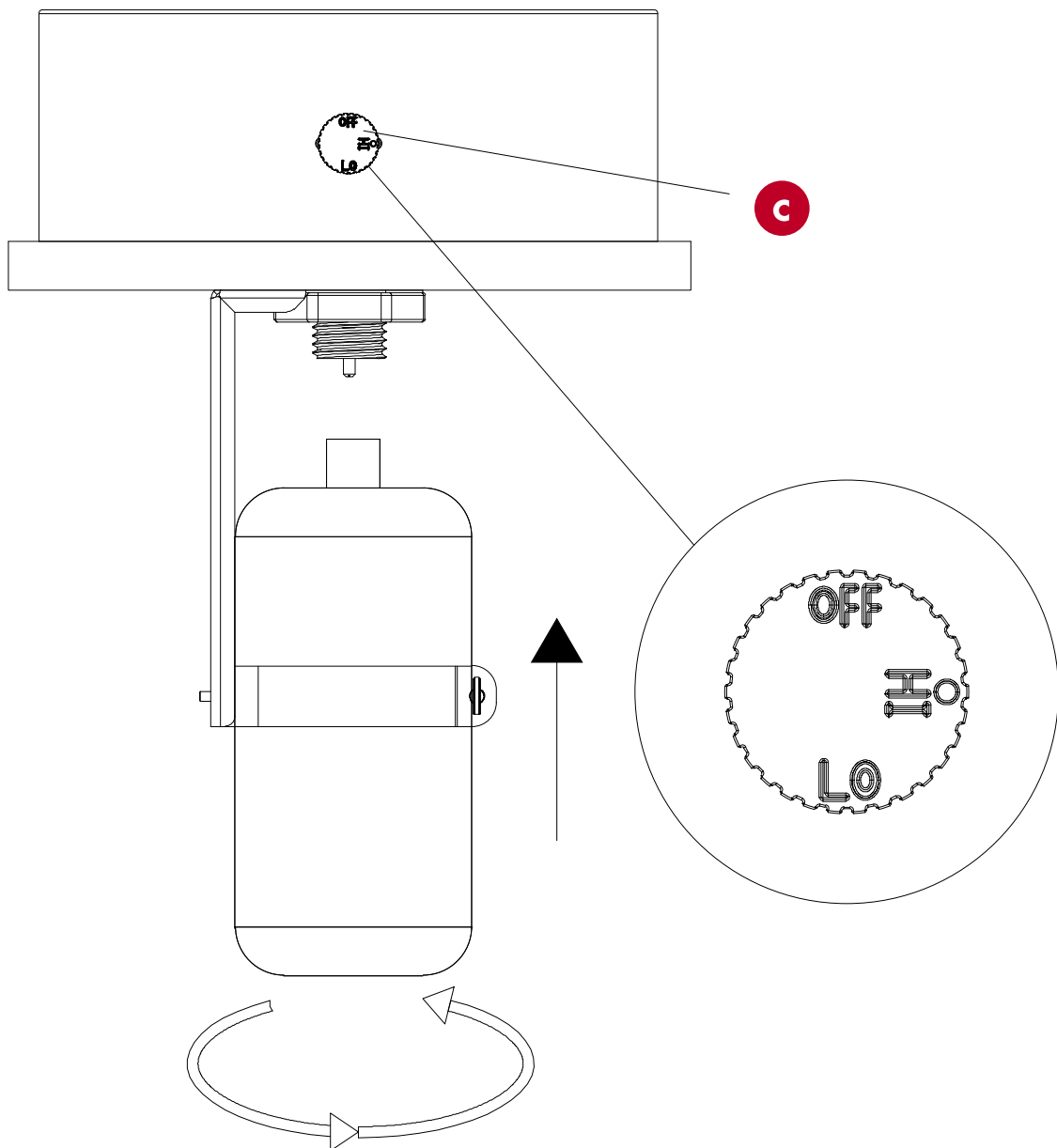

## STEP 5

Once the tank is attached to the regulator, Insert the wing screw (BB) into the tank bracket and turn clockwise to secure the propane gas tank tightly.

### **Danger**

Be cautious not to kick, jam or jar propane tank while it is attached to the firebowl.

**BB**



x1

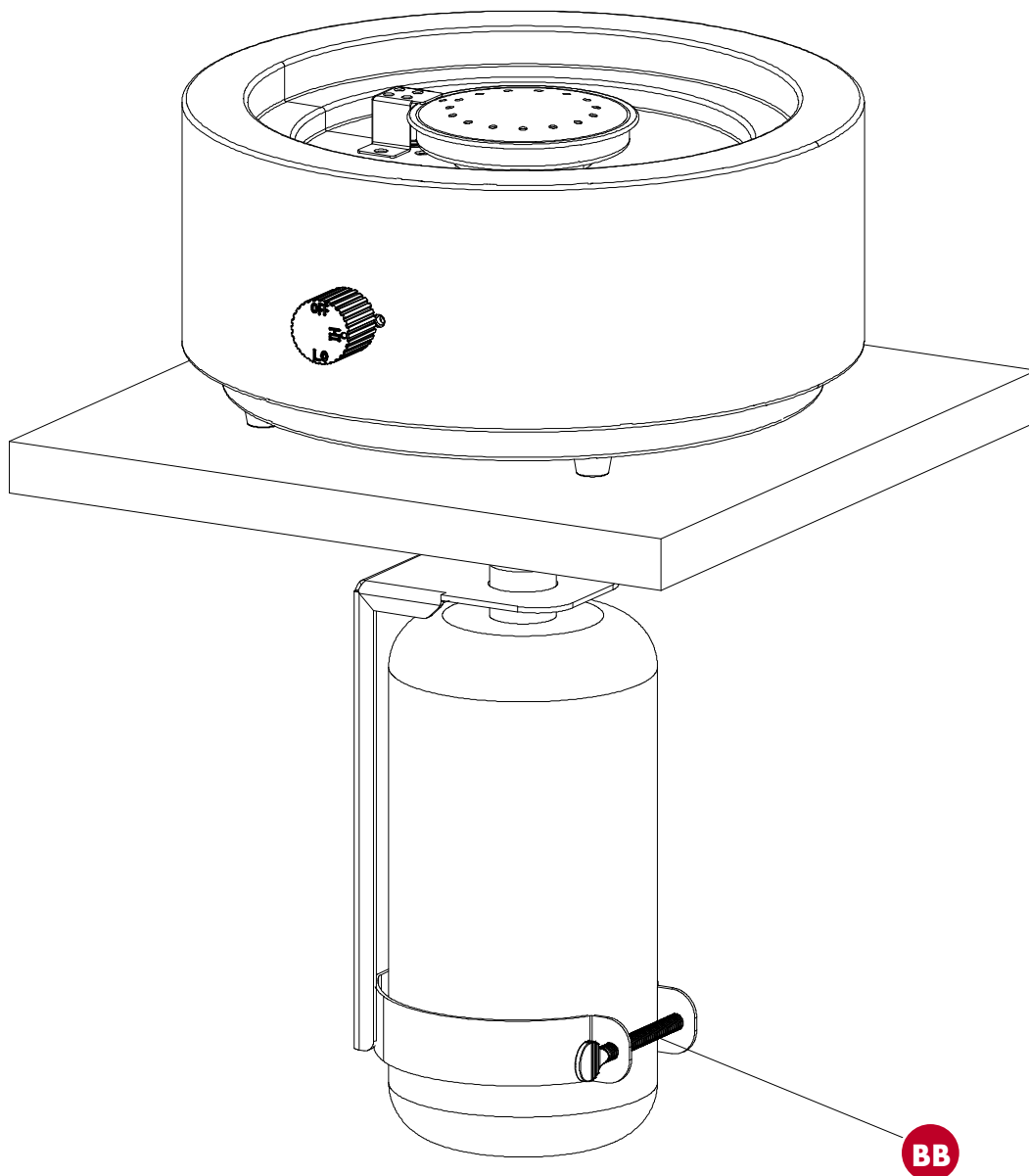

## STEP 6

Pour the Lava rocks (I) into the middle of the firebowl body (B) evenly.

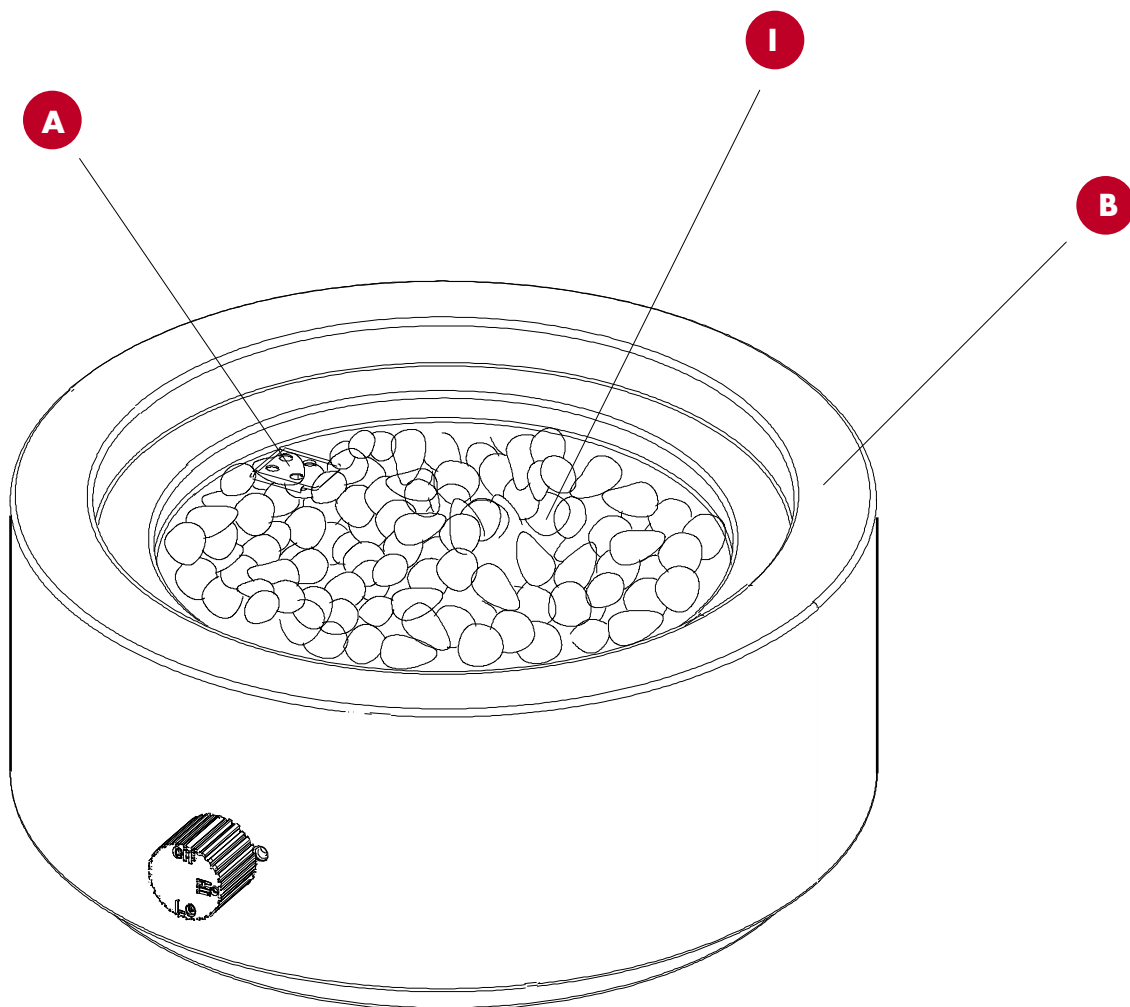
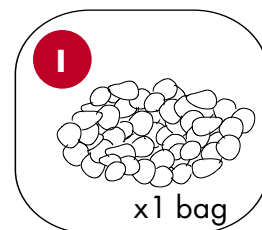

### **WARNING**

To ensure proper function, the guard (A) on the burner should be free of lava rocks (I) at all times.

Keep away from the unit and have the unit to burn 20 minutes for the first time use.

Always ensure that lava rocks/pumice stones/LavaGlass® are completely dry before use. Failure to do so will cause them to crack or pop.

---

# OPERATION

---

Before performing a leak test, be sure that no sparks can occur and you are in a spacious outdoor area. Connect the propane gas tank to the regulator and turn the valve on the unit to the 'OFF' position. Brush a soap and water mixture on all connections. Turn the gas supply on; if bubbles occur on any connection there may be a leak. If you smell gas or a leak is discovered turn the gas valve off, disconnect propane gas tank and do not use the appliance until the leak is repaired.

Do not use the heating unit without inspecting the gas hose. If there are signs of wear or abrasion you must replace the hose (if applicable). Pumice stones/lava rocks/LavaGlass® could pop up and strike somebody's face during the process of lighting this unit; stand away from the unit for the first 20 minutes after igniting. Flame should be a yellow/blue color and between 2 - 10 inches in height.

Wait 50 minutes after extinguishing flame prior to placing a lid (if applicable) or protective cover on heating item.

## LIGHTING

1. Turn ignition control knob (L ) to the "OFF" position. Connect propane gas tank to regulator and open the cylinder valve.
2. Push the ignition control knob (L ) in and turn counterclockwise to the "HIGH" position; this will ignite the fuel. Keep holding down the control knob for 15 seconds.
3. If ignition does NOT immediately take place in seconds, push and turn the ignition control knob (L ) clockwise to "OFF". Wait 5 minutes, then repeat the lighting procedure as above.
4. To adjust the flame, turn the ignition control knob (L ) either clockwise or counterclockwise depending on whether you want to lower or raise the flame.

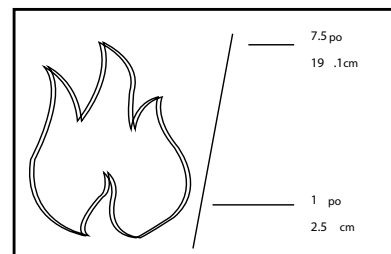

**⚠ WARNING** - If the burner does not ignite with the burner control valve open, gas will continue to flow out of the burner and could accidentally ignite causing injury or property damage.

## EXTINGUISHING

1. Push and turn the ignition control knob (L ) clockwise to the "OFF" position.
2. Turn the propane gas tank valve on the gas tank to close the gas supply and disconnect the propane gas tank.

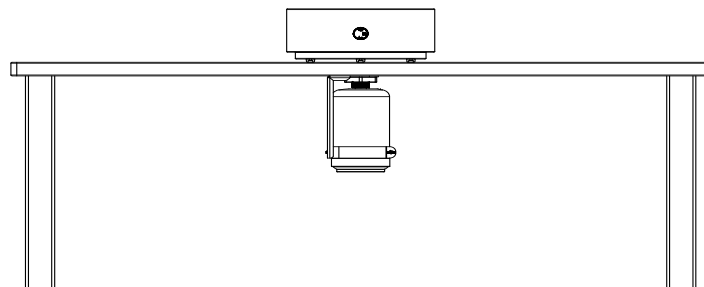
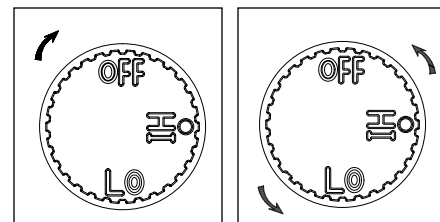

---

## TROUBLESHOOTING

---

	CAUSE	SOLUTION
Burner won't light while using a match	No gas flow	Check that the gas tank isn't empty
	Regulator isn't connected securely to the tank	Tighten regulator connection to the gas tank
	Spider webs or insect nest in the burner and guard	Check the burner and guard
	Burner ports are clogged	Turn all gas flow connections off. Insert an opened paperclip (or similar item) into each of the burner ports to clear them out.
Heating unit emits a lot of black smoke	Flame is obstructed at burner ports	Check that all burner ports are free of any small lava rocks/pumice stones/Lava- Glass® pieces
Flame blows out easily	High or gusting winds	Increase flame to 'HIGH'
	No gas flow	Check that the gas tank isn't empty

---

# MAINTENANCE

---

- Before performing any maintenance always disconnect propane gas tank.
- Store your product indoors during winter months. Avoiding extreme cold temperatures will prevent from exposure damage.
- Keep the heating item free and clear from combustible materials.
- Visually inspect burner for obstructions and keep tank enclosure free and clear from debris.
- Use a soft brush to get rid of the mild stains, loose dirt and soil after the burner and pumice stones/ lava rocks/ LavaGlass® are completely cooled down. Wipe down with a soft cloth.
- Harsh weather conditions may cause stubborn stains, discoloration and possibly rust pitting.
- Permanent damage may occur if powder or solvent comes in contact with painted or plastic components on this heating unit.
- Keep the heating unit stored away from direct sunlight.
- If storing this unit inside, disconnect the propane gas tank from the gas valve.
- Not using manufacturer approved or supplied parts/accessories may result in a defective condition and void the warranty of this heating unit.
- Always place lid (if applicable) or protective cover on heating item when not in use.

---

# WARRANTY

---

This product has a one-year warranty against manufacturing defects in workmanship, or materials.

The manufacturer warranty will be voided by, and manufacturer disclaims any responsibility for, the following actions:

- Modification of the unit and/or components including the gas valve assembly.
- Use of any component part not manufactured or approved by Manufacturer.
- Use and installation other than what is listed in this manual.

---

# CONTACT

---

If you have any questions or concerns, please contact manufacturer at the below resources:

Toll free phone: **1-877-447-4768 | Monday - Friday, 8:00 am - 4:30 pm CST**

Email: **customerservice@ghpgroupinc.com**

Website: **www.ghpgroupinc.com**