

## **ASSEMBLY INSTRUCTIONS**

ITEM#: 7022-1

SKU#: 810531300

---

# **END TABLE**

---

Need help? We are here for you!  
[www.biglots.com/help/contact-us](http://www.biglots.com/help/contact-us)

---

## GENERAL BEST PRACTICES FOR ASSEMBLY:

---

- \*Please read the assembly instructions prior to assembling this product.
- \*Determine you have adequate space for assembly.
- \*Assembly by two adults is recommended.
- \*Assemble on soft surfaces to prevent damage to product finish.
- \*Keep children away during assembly. This item contains small parts which can be swallowed by children.
- \*Do not discard any of packaging until you have checked that you have all the parts and hardware.
- \*Retain the assembly instructions for further reference.
- \*The manufacturer will not accept responsibility for unauthorized repairs or modifications to this product.

---

## WARNINGS:

---

- \*DO NOT use power tools.
- \*Remove all packaging material, make sure all parts are present before assembly.
- \*Should this product become damaged, and/or components are broken or missing, DO NOT USE.
- \*This product will burn if left in contact with flame source.

---

## MAINTENANCE:

---

- \*DO NOT use any chemical cleaners. Hardware may loosen over time.
- \*Periodically check all bolts and fully tighten any that are loose.

---

## PARTS LIST

---

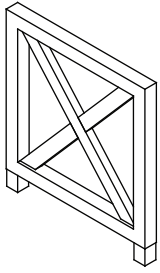

**A**

Leg Frame  
x 2pcs

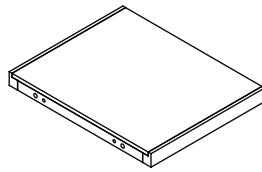

**B**

Top Panel  
x 1pc

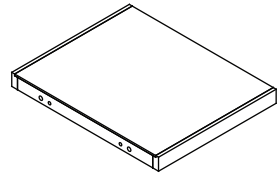

**C**

Bottom Panel  
x 1pc

---

## HARDWARE LIST

---



**1**

Allen Bolt x 8pcs  
Ø5/16" x 42mm

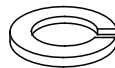

**2**

Lock Washer x 8pcs  
Ø5/16" x 13mm

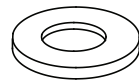

**3**

Flat Washer x 8pcs  
Ø5/16" x 22mm

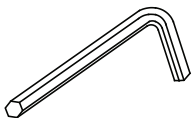

**4**

Allen Key x 1pc  
Ø5mm

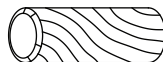

**5**

Wood Dowel x 8pcs  
Ø10 x 30mm

# STEP 1

## HARDWARE NEEDED

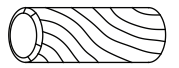

5

x8

Place all the parts onto a solid nonabrasive surface such as carpet or a cloth to prevent damage to the End Table. Insert the Wood Dowels (5) into the smaller holes of the Top Panel (B) and the Bottom Panel (C). Then connect the Top Panel (B) and the Bottom Panel (C) to the Leg Frames (A).

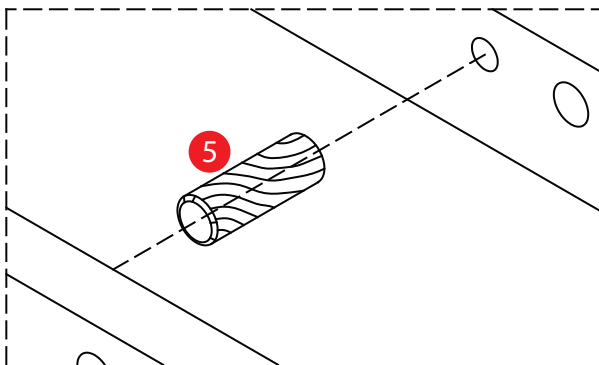
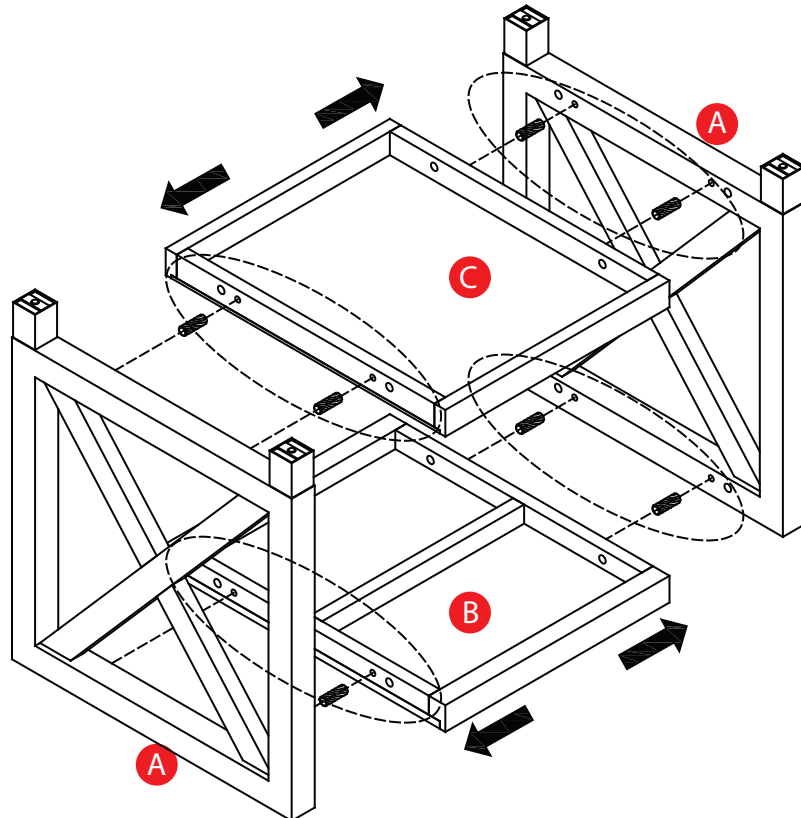

Assembled View:

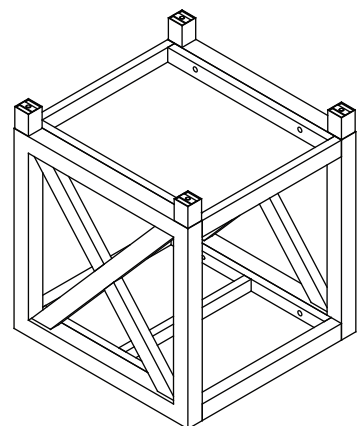

## STEP 2

### HARDWARE NEEDED

Secure the Top Panel (B) and the Bottom Panel (C) to the Leg Frames (A) with Allen Bolts (1), Lock Washers (2) and Flat Washers (3) using Allen Key (4). Make sure that edges the Top Panel (B) and the Bottom Panel (C) are aligned with edges of the Leg Frames (A). Fully tighten the Allen Bolts at this time.

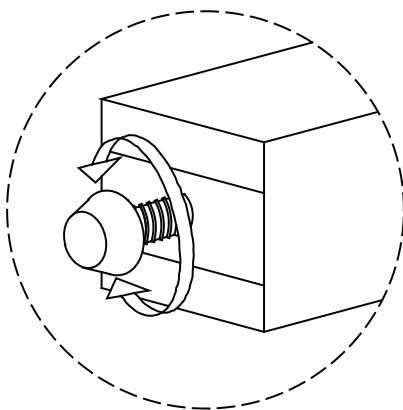
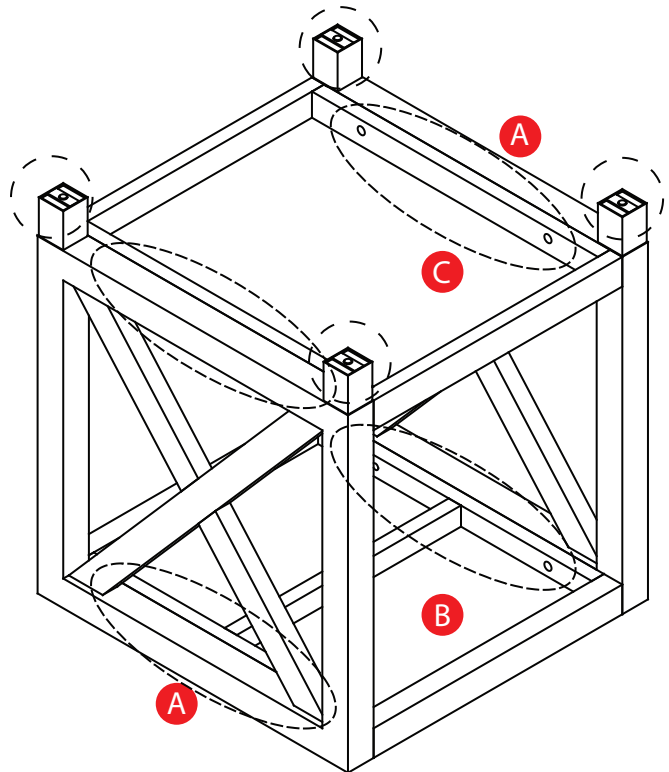
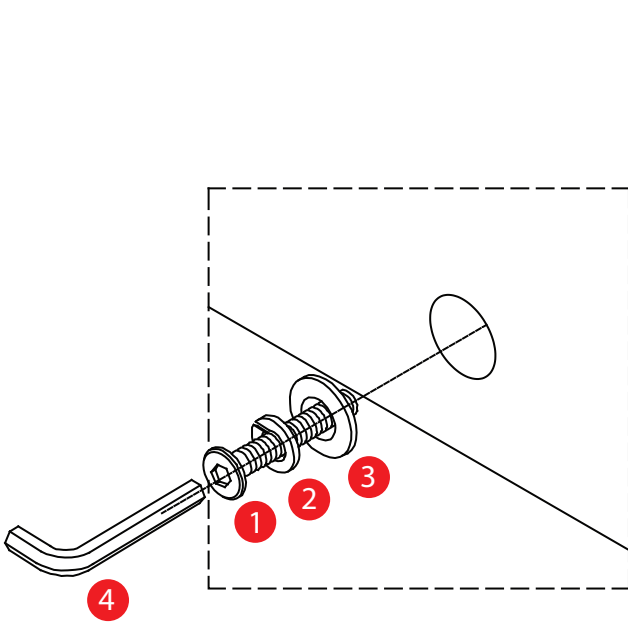
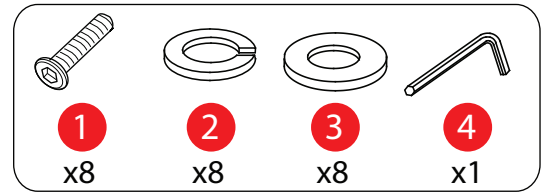

Adjustable

Assembled View:

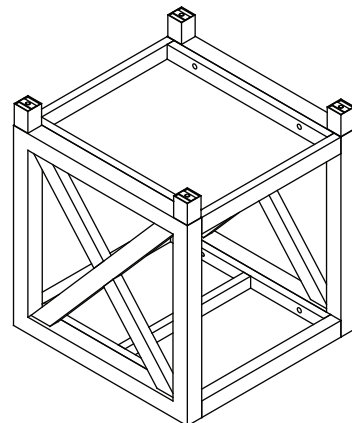

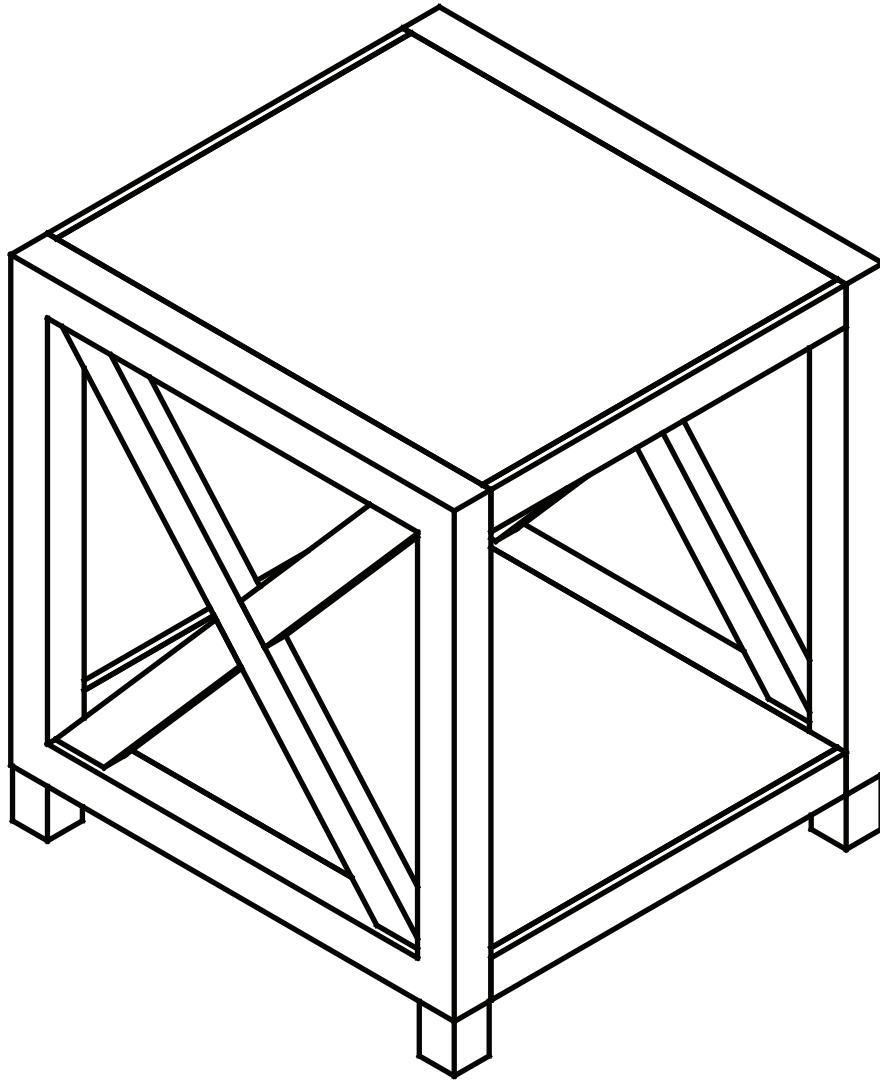

ASSEMBLY IS COMPLETED