

# Assembly Instruction

Item No. :HG-4288

SKU No. :810465634

Description:Farmhouse Grey Fabric Office Chair

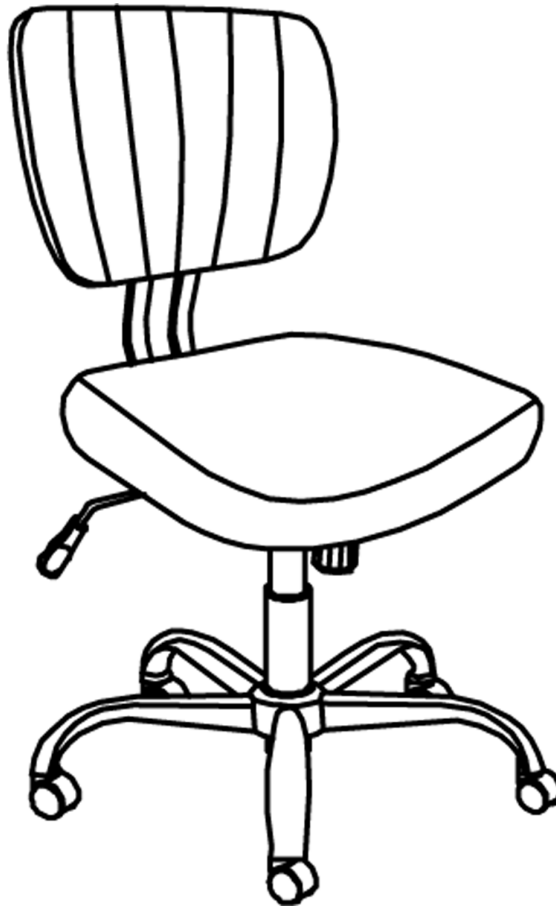

## **WARNING**

Caution: Adult assembly required.

Assemble on soft surfaces to prevent damage to the product finish.

DO NOT use power tools.

## **CARE AND CLEANING**

DO NOT scratch or chip the finish. DO NOT use abrasive chemicals for cleaning.

Clean with dry cloth thoroughly.

## **MAINTENANCE**

Check bolts/screws periodically and tighten if necessary.

**WARNING:** Should this product become damaged, and/or components are broken or missing, DO NOT USE.

**For spare hardware, please contact Big Lots Customer Care**

**Tel:1-866-244-5687**

**E-Mail:talk2us@biglots.com**

**Tools Required  
(Included)**



**Allen key**

**Hardware  
included**

**A**



**8PCS**

**B**



**2PCS**

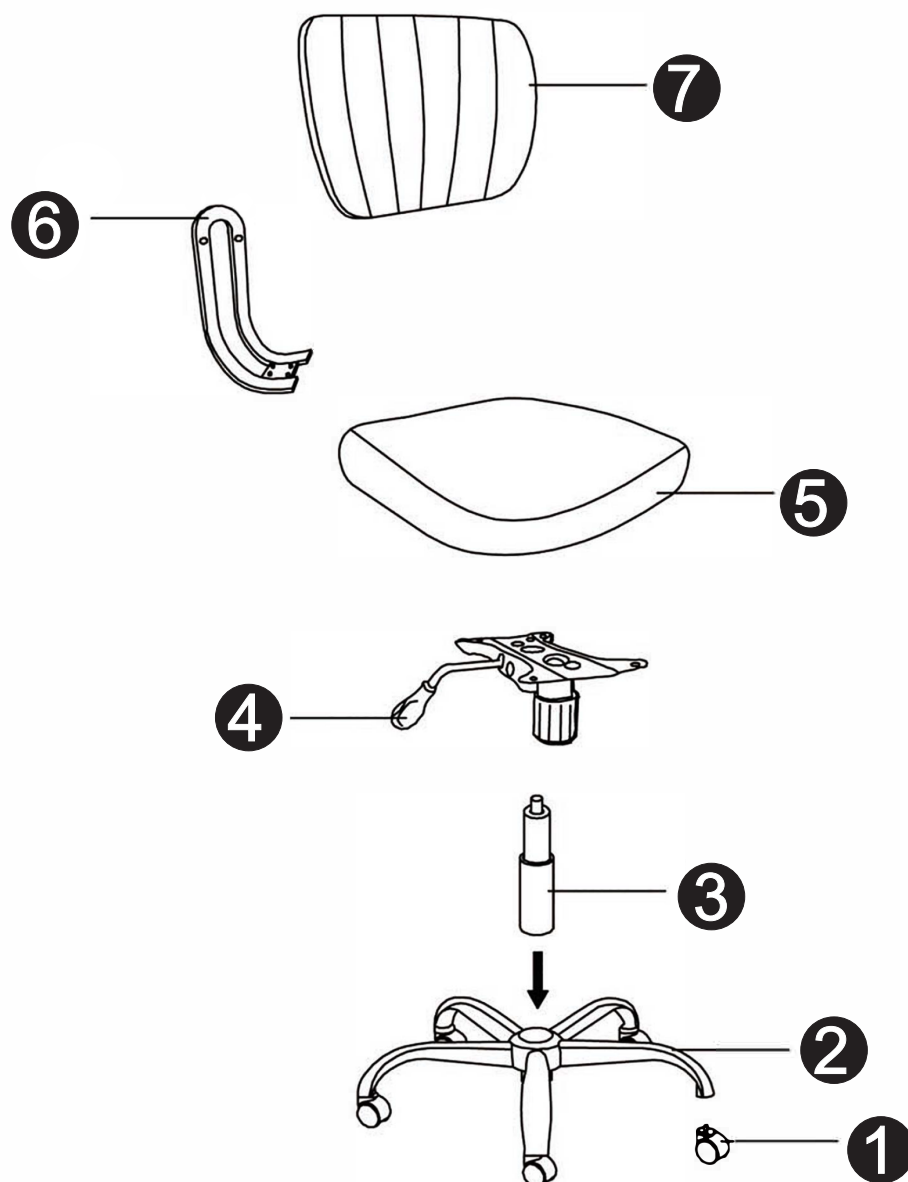

The above diagram is a guide to help you to identify the different parts of the unit when removing them from the packaging. Please follow the listed steps in order to complete the assembly process.

## STEP1

Insert part (1) into part (2)  
as shown in the diagram.

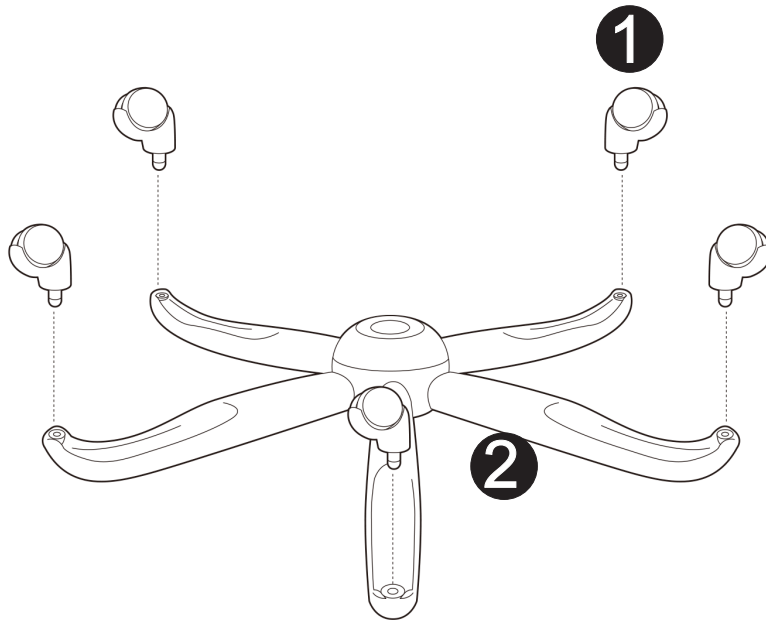

## STEP2

Turn part (2) onto the  
wheels. Insert part (3) into  
the center hole as shown in  
the diagram.

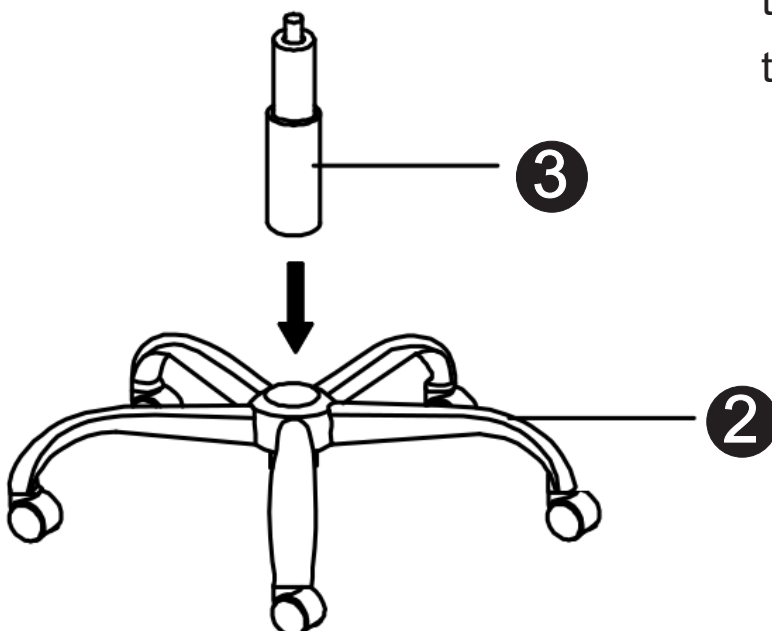

## STEP3

Align the holes in part (4) with the holes in part (5). Using screws (A) and Allen Key, attach part (4) to part (5) as shown in the diagram. Fully tighten all screws.

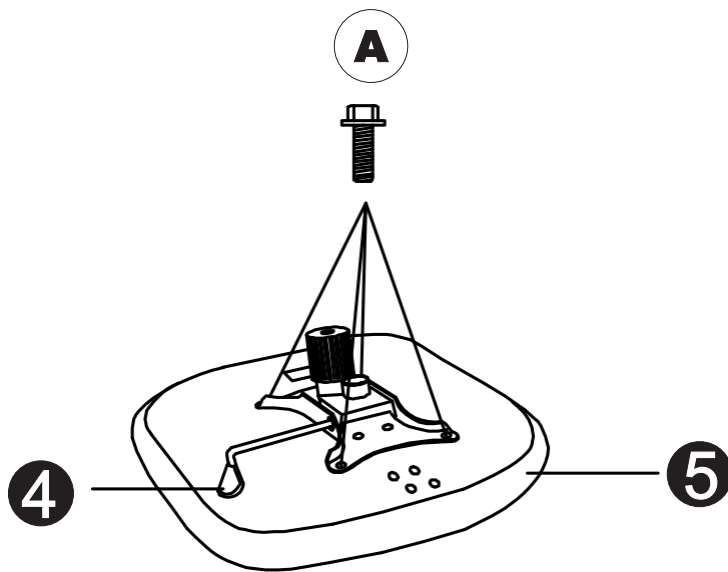

## STEP4

Align the holes in part (6) with the holes in part (5). Using screws (A) and Allen Key, attach part (6) to part (5) as shown in the diagram. Fully tighten all screws.

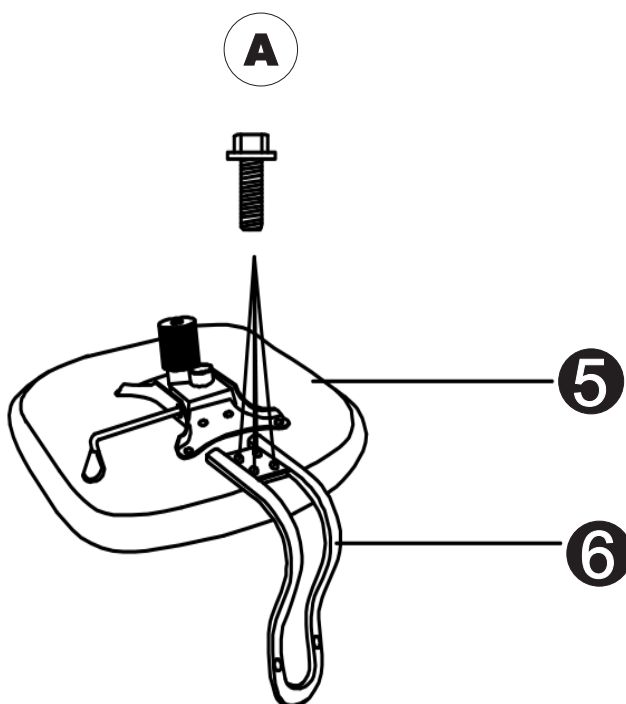

## STEP5

Align the holes in part (7) with the holes in part (6). Using screws (B) and Allen Key, attach part (7) to part (6) as shown in the diagram. Fully tighten all screws.

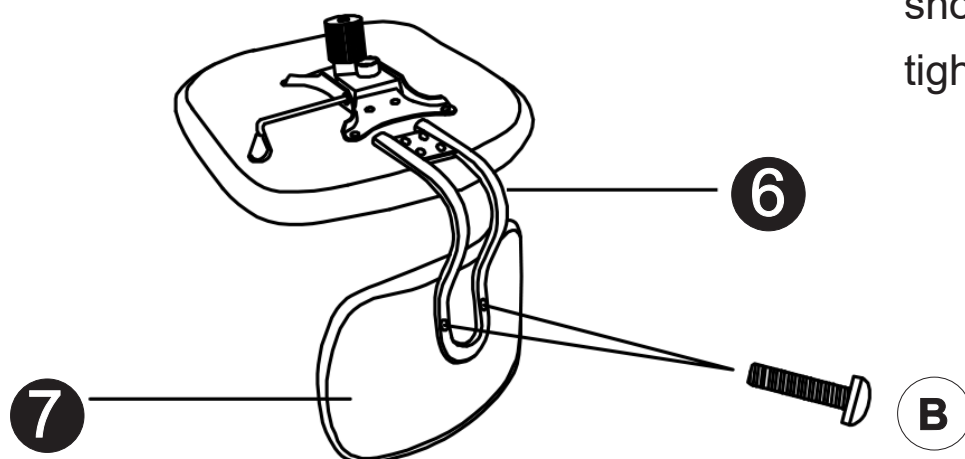

## STEP6

Align the center hole of part (4) with the top of part (3) and press firmly into place. Assembly is now complete. Use the lever to raise and lower the seat as desired.

